



United Nations
Educational, Scientific and
Cultural Organization



World
Heritage
Convention

Fastening systems for towel rails radiators

The Verona Arena is a Roman amphitheatre in Piazza Bra in Verona, Italy built in the first century. It is one of the best preserved ancient structures of its kind. In ancient times, the arena's capacity was nearly 30,000 people.



FIX IT



ISO 9001



interseroh
zero waste solutions

Interseroh zero waste solutions



Hexavalent chromium free



Made in Italy



ARENA DI VERONA

1 h 31 min



FIX IT

Creativity makes the world a safer place!

We want to make the world a safer place thanks to the creativity of our mechanical fixings,
customized to every aesthetic and functional need.



FIX IT

BRACKETS READY FOR INSTALLATION

Two ready-to-install floor brackets for decorative double flat tube radiators, vertical and horizontal mounting, for finished floor configuration.



60790030	2x PGF 35-38	1	300
----------	--------------	---	-----

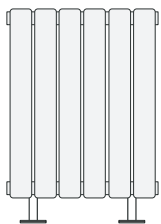

PGF
For vertical flat tubes



PGF
For horizontal flat tubes



PGF for horizontal flat tubes

Measures are expressed in millimeters

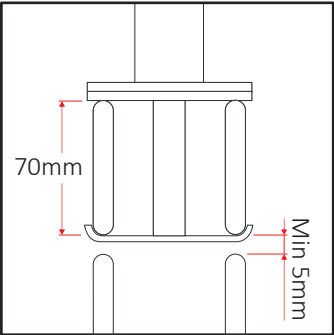

PGF for vertical flat tubes

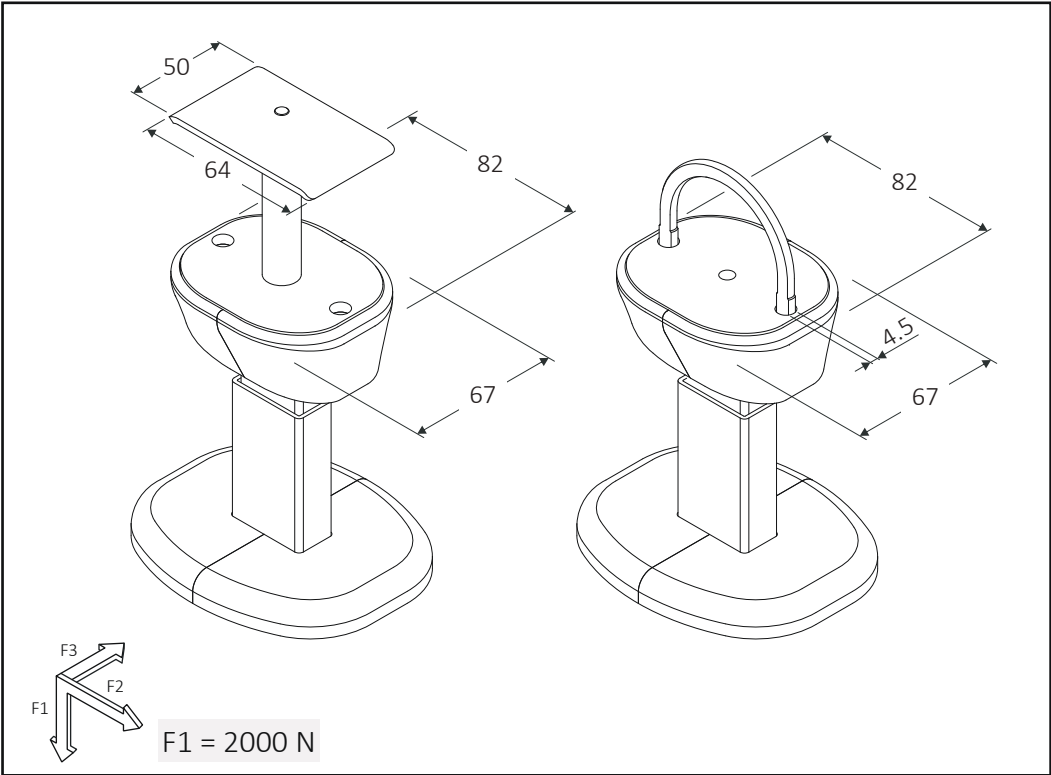
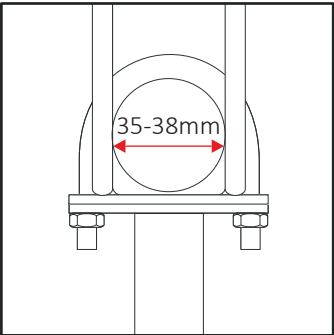

BRACKETS READY FOR INSTALLATION

Ready-to-install bracket kit for lateral fixing, consisting of: foot on the ground STD2 and wall fixing STD1. The last mentioned, specific for radiators with "D" 40x30 mm manifold.



60400800	2x STD1 + 1x STD2 + 3x QKF		1	500
60401000	2x STD1 + 1x STD2 + 3x QKF		1	500

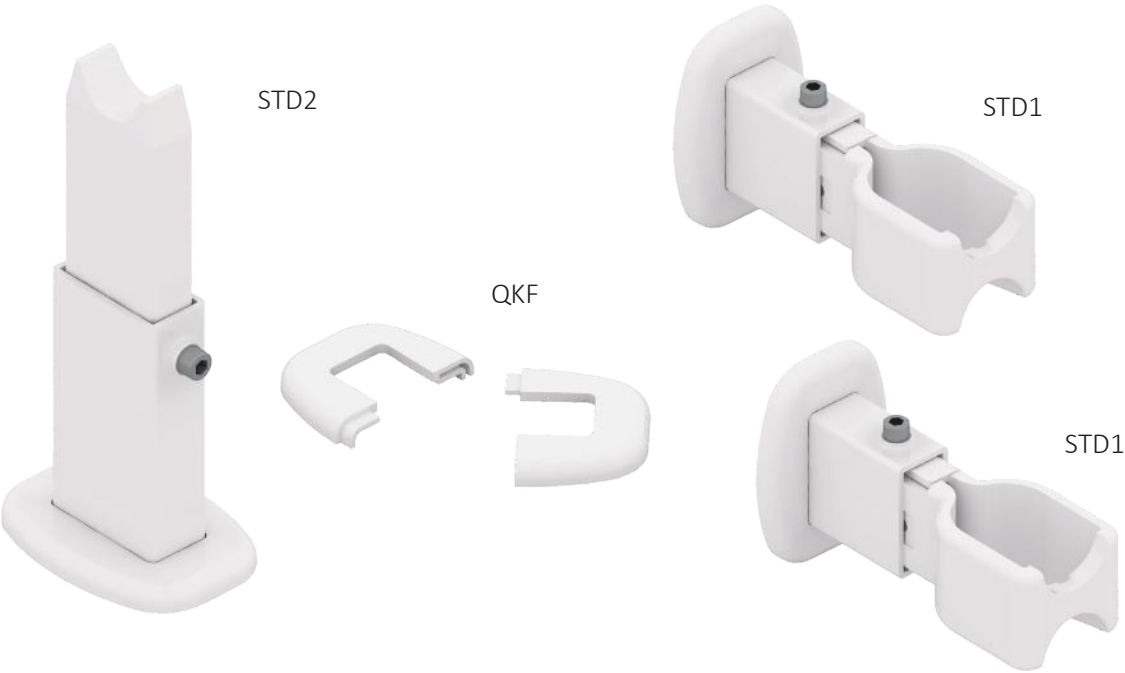

Regulation STD1 and STD2

Measures are expressed in millimeters

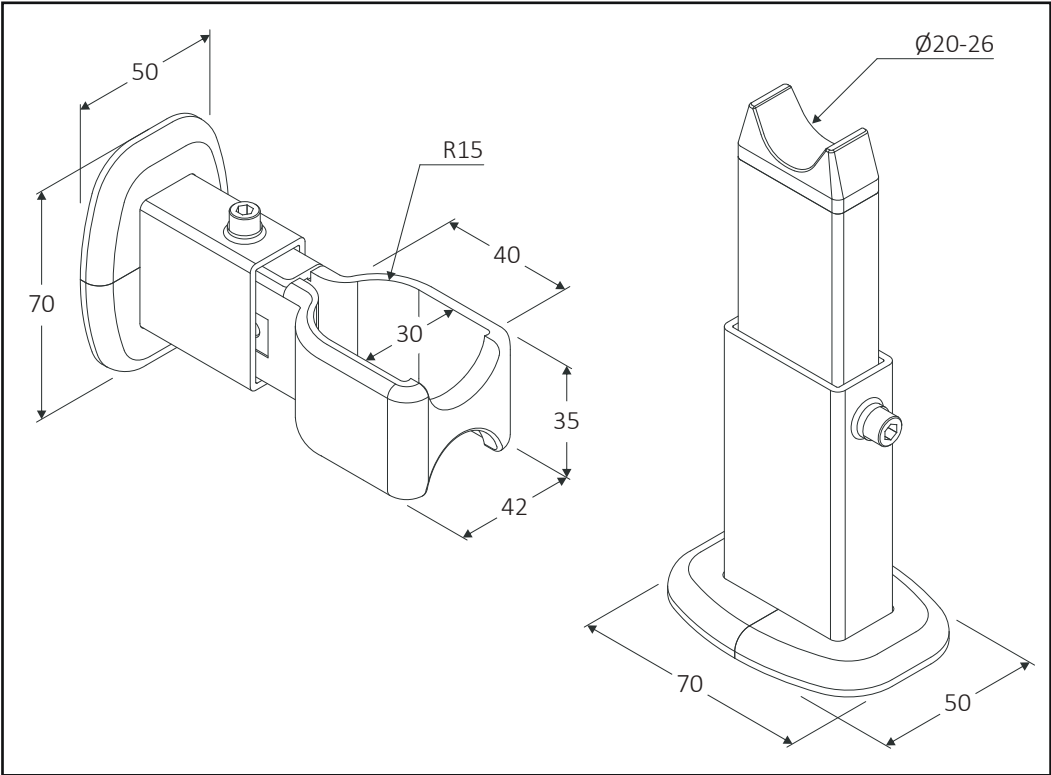
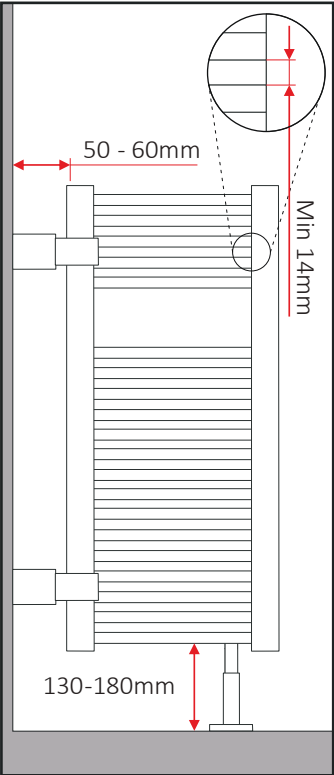

BRACKETS READY FOR INSTALLATION

Floor support brackets for bathroom radiators, white version.



60400816D	1x STD FISTONE	60	960
-----------	----------------	----	-----



STD
Fistone
Regulation 1



STD
Fistone
Regulation 2

Regulation 1

Measures are expressed in millimeters

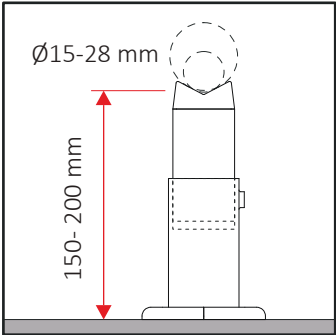

Regulation 2

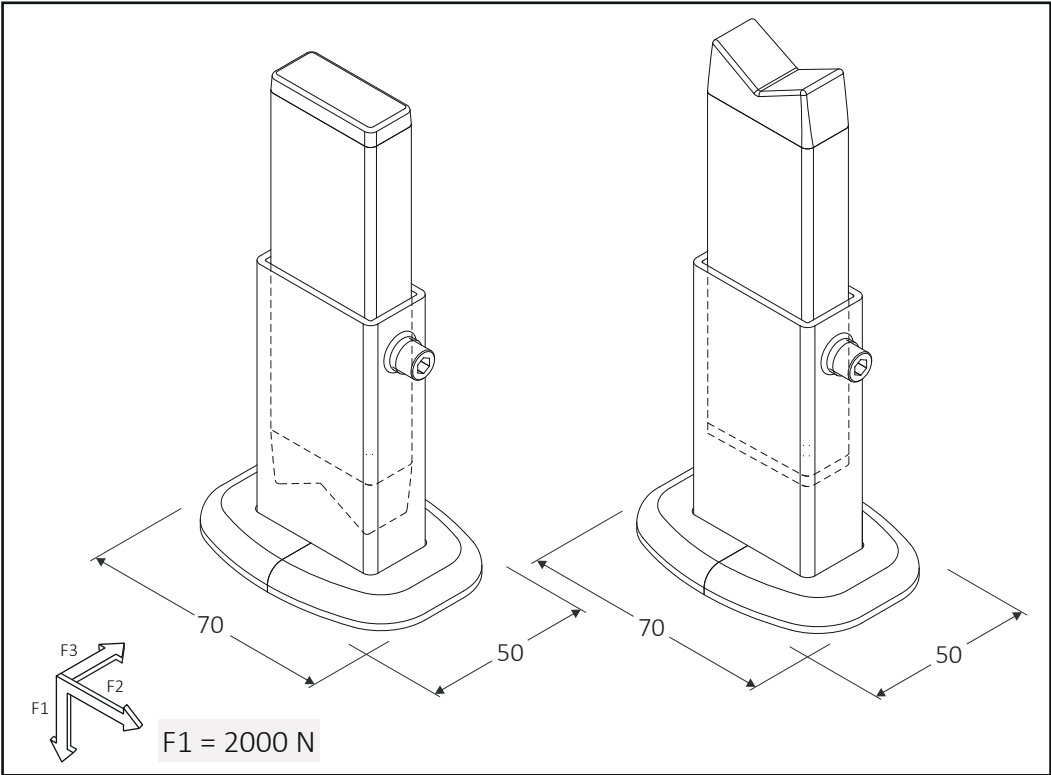
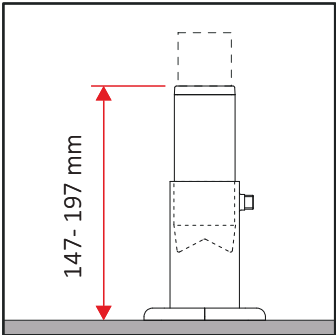

WALL BRACKETS

Ready-to-install wall brackets for bathroom radiators, available in versions with straight and curved tubes. For tubes with diameter 16-17 mm and center distance 28-30 mm.



60214100	3x STN-S			AK3	90	1080
60224900-S	4x STN-S + 4x SR			AK3	60	720
60214800	3x STN-S			AK3	90	1080
60224800-S	4x STN-S + 4x SR			AK3	60	720



STN-S
White



STN-S
Chrome

Dimensions towel radiator

Adapter SR

Measures are expressed in millimeters

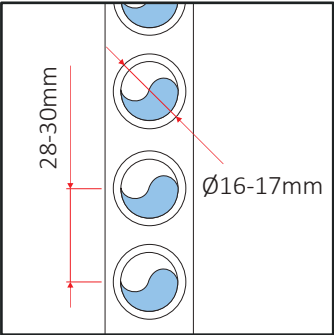

Regulation STN-S

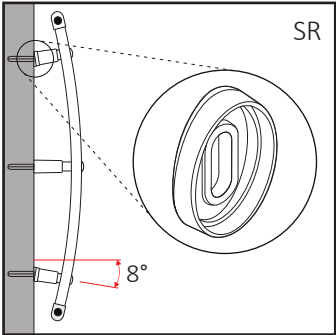

Extension SL

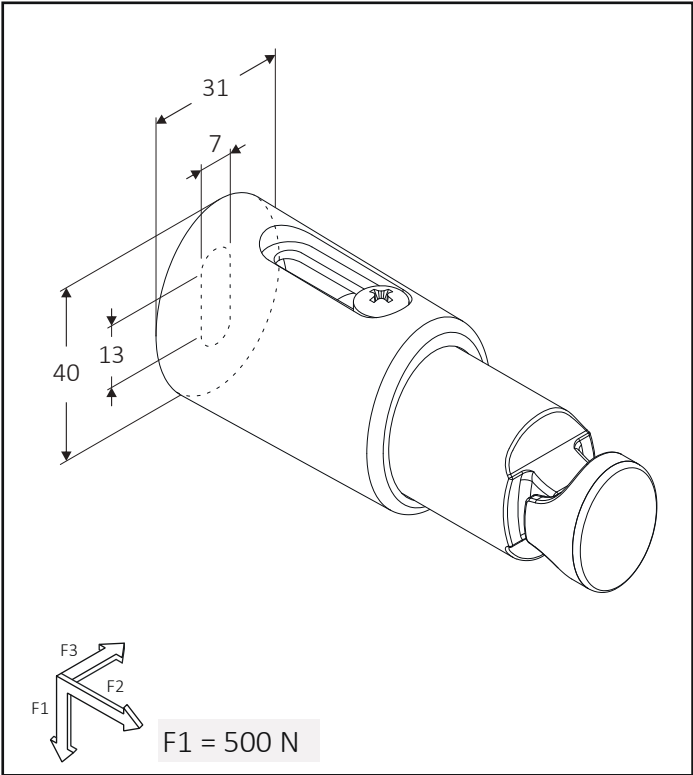
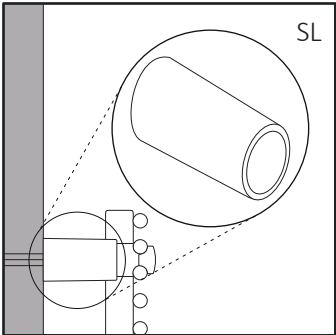
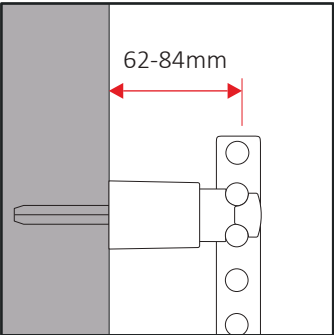

WALL BRACKETS

Ready-to-install wall brackets for bathroom radiators, available in versions with straight and curved tubes. For tubes with diameter 16-25 mm and center distance 28-42 mm.



60213900S	3x STN			AK3	90	1080
60224900S	4x STN + 4x SR			AK3	60	720
60213800S	3x STN			AK3	90	1080
60224800S	4x STN + 4x SR			AK3	60	720



STN
White



STN
Chrome

Dimensions towel radiator

Adapter SR

Measures are expressed in millimeters

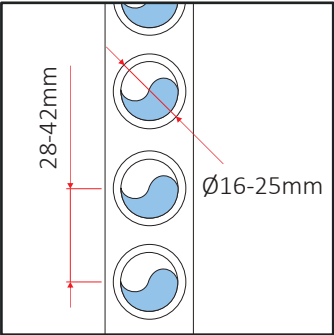

Regulation STN

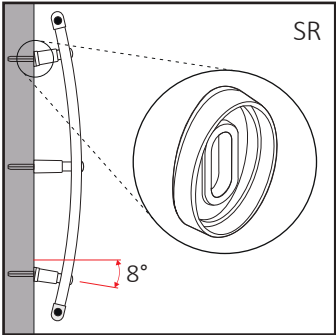

Extension SL

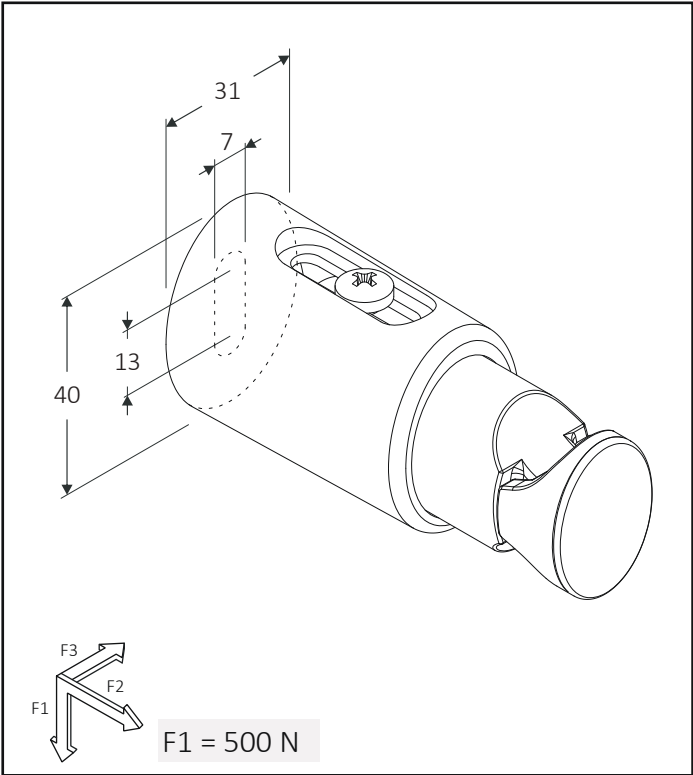
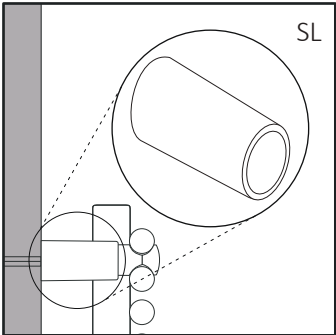
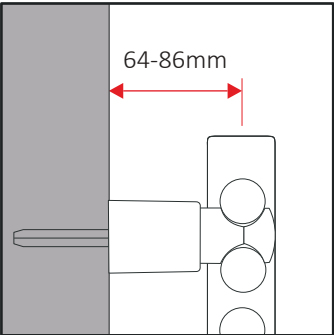

WALL BRACKETS

Ready-to-install wall brackets for bathroom radiators, available in versions with straight and curved tubes. For tubes with diameter 16-25 mm and center distance 30-46 mm.



60233100	3x STN-I			AK3	90	1080
60234120	4x STN-I + 4x SR			AK3	60	720
60233700	3x STN-I			AK3	90	1080
60234720	4x STN-I + 4x SR			AK3	60	720



STN-I
White



STN-I
Chrome

Dimensions towel radiator

Adapter SR

Measures are expressed in millimeters

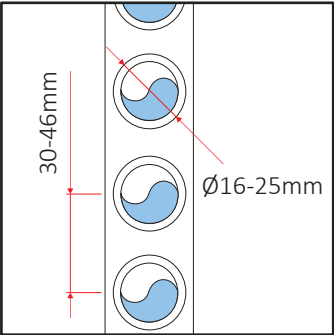

Regulation STN-I

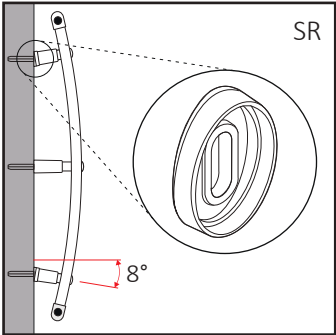

Extension SL

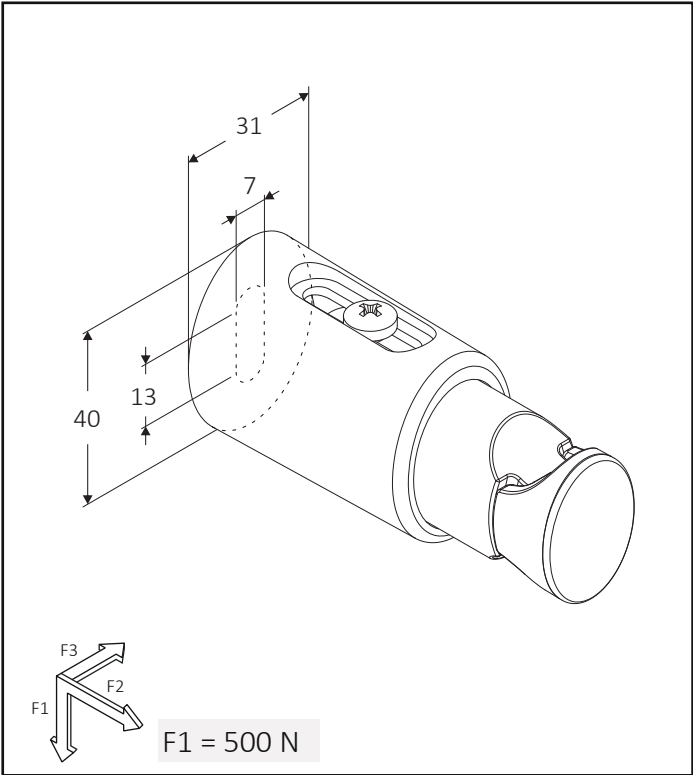
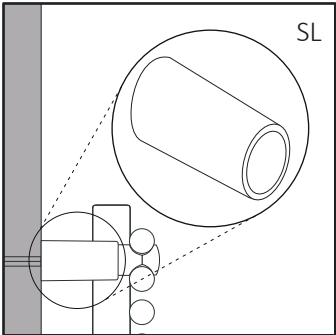
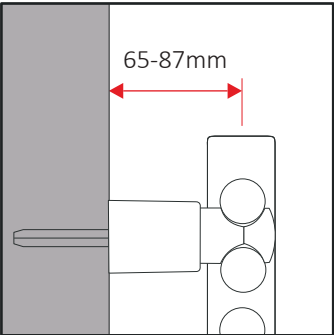

WALL BRACKETS

Ready-to-install wall brackets for bathroom radiators, available in versions with straight and curved tubes. For tubes with diameter 16-25 mm and center distance 36-48 mm.



60313600	3x STN-N			AK3	90	1080
60324600	4x STN-N + 4x SR			AK3	60	720
60313800	3x STN-N			AK3	90	1080
60324800	4x STN-N + 4x SR			AK3	60	720



STN-N
White



STN-N
Chrome

Dimensions towel radiator

Adapter SR

Measures are expressed in millimeters

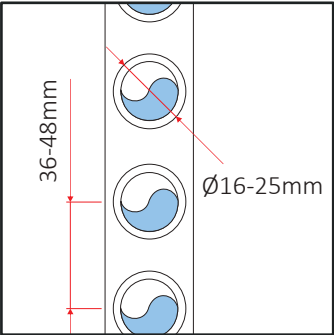

Regulation STN-N

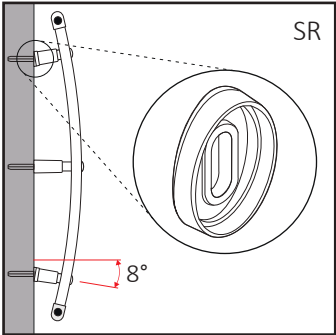

Extension SL

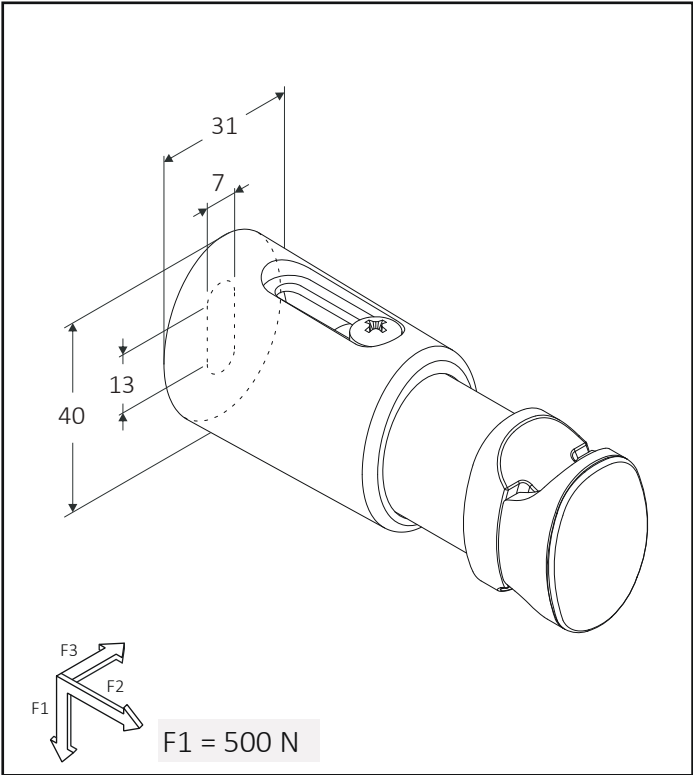
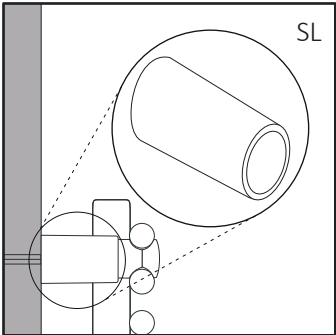
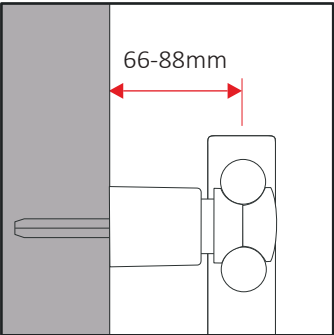

WALL BRACKETS

Ready-to-install clamp bracket for bathroom radiators with tube diameter 22-23-24-25, in white, chrome and transparent version, the last mentioned specifically for colored radiators. Available in straight and curved tube versions.



60210022	3x STF Ø 22		50	600
60214022	4x STF Ø 22		50	600
60210025	3x STF Ø 25		50	800
60214025	4x STF Ø 25		50	800



STF
White

PATENTED

60270022	3x STF Ø 22		50	600
60274322	4x STF Ø 22		50	600
60270025	3x STF Ø 25		50	800
60274325	4x STF Ø 25		50	800



STF

Metallized

PATENTED

60210122T	3x STF Ø 22		50	600
60214022T	4x STF Ø 22		50	600
60210125T	3x STF Ø 25		50	800
60214025T	4x STF Ø 25		50	800



STF

Transparent

PATENTED

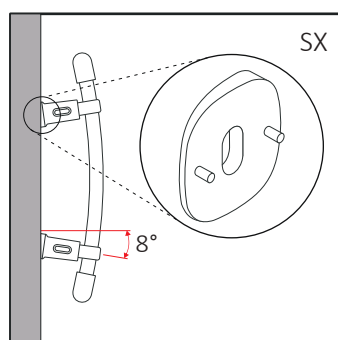

Regulation STF

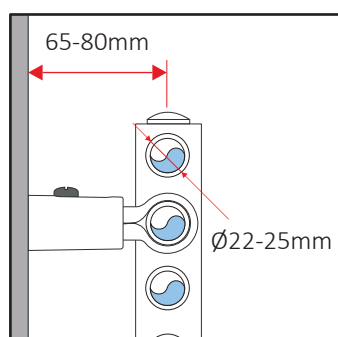

Assembly Instructions

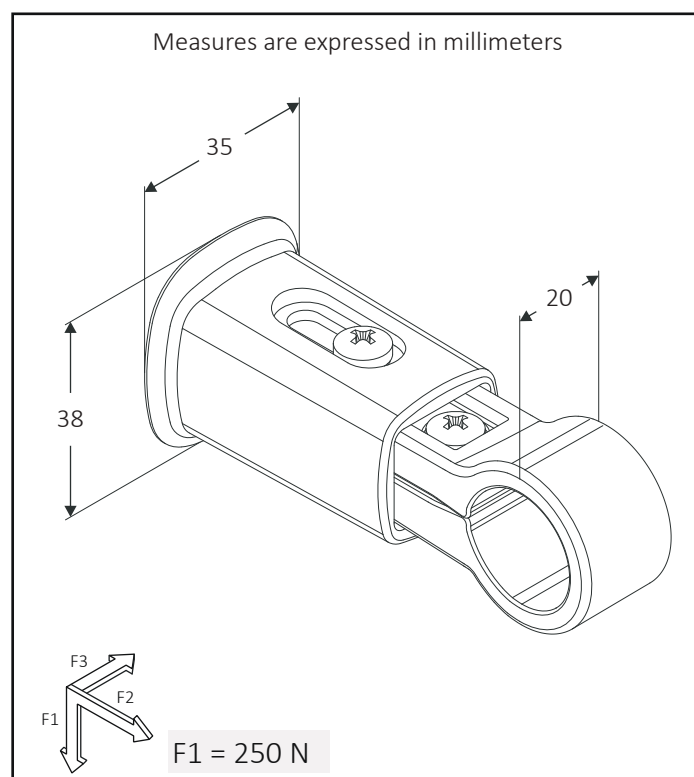

WALL BRACKETS

Ready-to-install wall brackets for flat-tube decorative radiators, available for the single-tube version.

				
60403000	3x STP		70	840
60404000	4x STP		50	800
60473000	3x STP		70	840
60474000	4x STP		50	800



STP
White



STP
Chrome

Regulation STP

Measures are expressed in millimeters

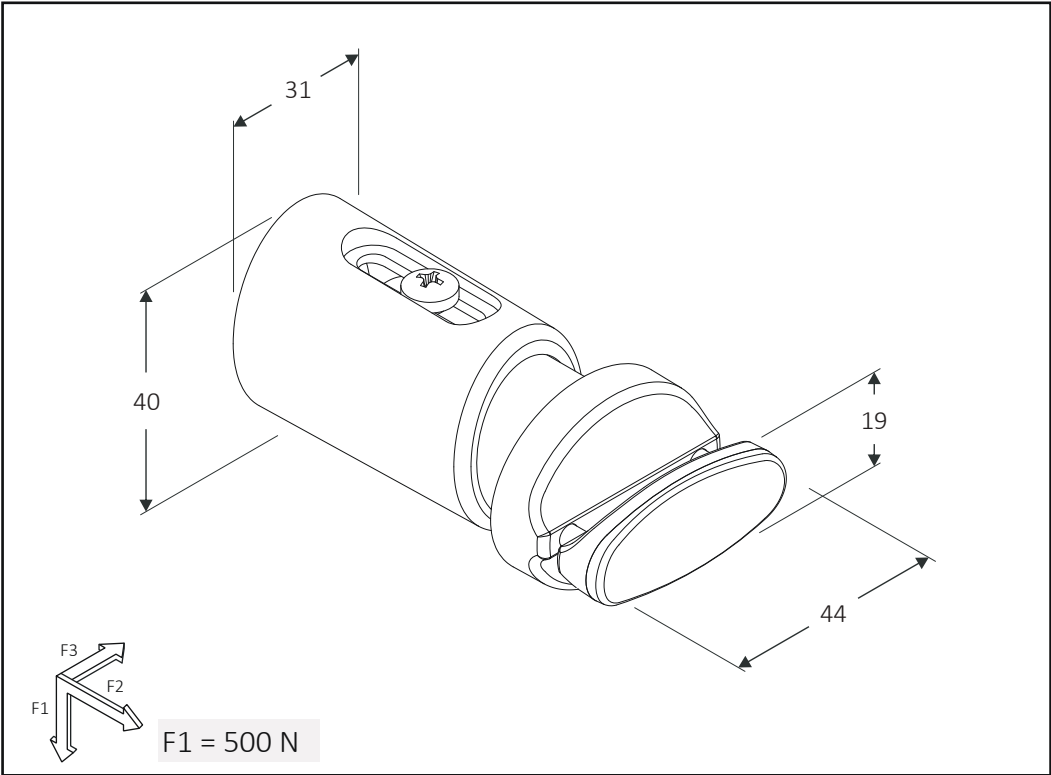
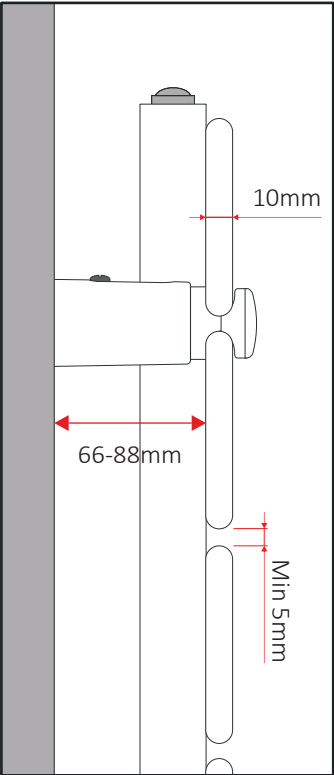

WALL BRACKETS

Brackets for quick wall installation of bathroom radiators with support, possibility of distance adjustment from the wall, white insulators included- galvanized version.



60210171	2x EN1	50	2750
60210180	2x G1	50	2750
60210171R	4x EN1R	50	2750



EN1



G1

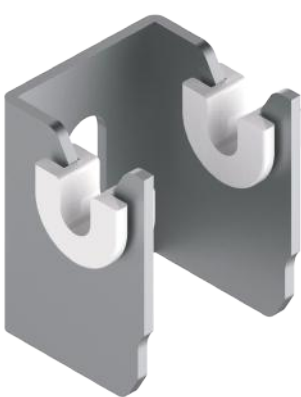

EN1R

Regulation EN1

Measures are expressed in millimeters

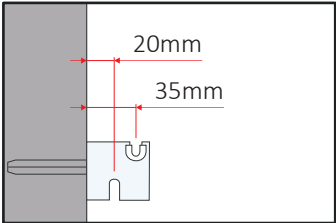

Regulation G1

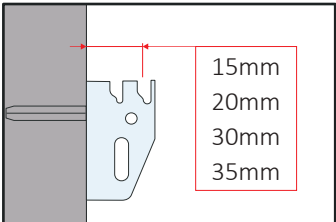

Regulation EN1R

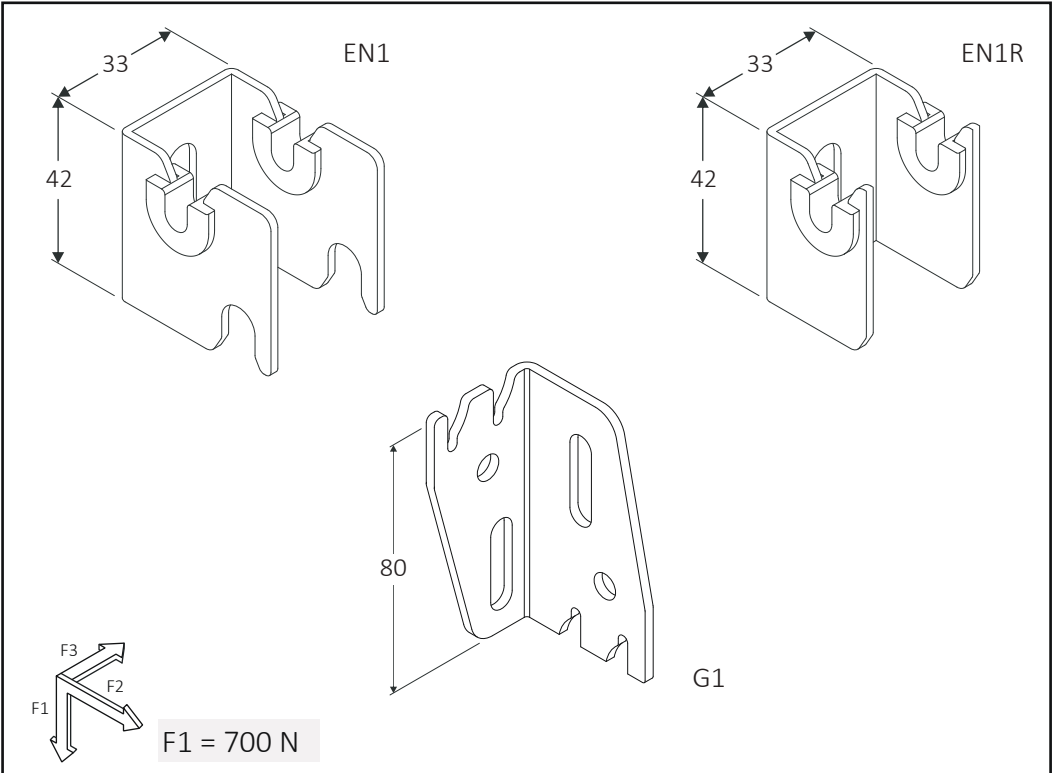
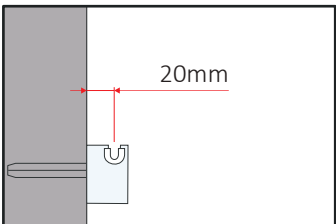

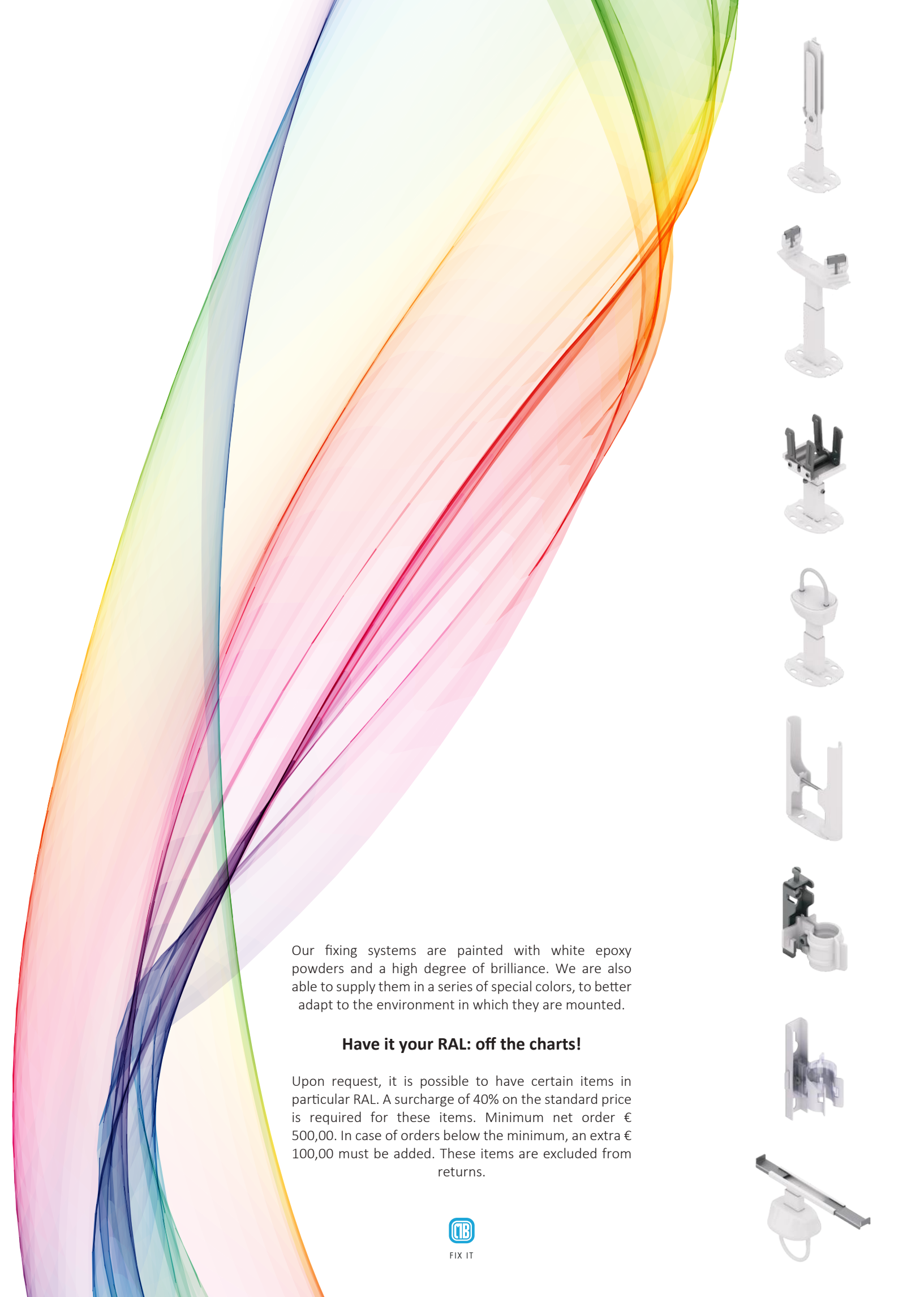

Our fixing systems are painted with white epoxy powders and a high degree of brilliance. We are also able to supply them in a series of special colors, to better adapt to the environment in which they are mounted.

Have it your RAL: off the charts!

Upon request, it is possible to have certain items in particular RAL. A surcharge of 40% on the standard price is required for these items. Minimum net order € 500,00. In case of orders below the minimum, an extra € 100,00 must be added. These items are excluded from returns.





The recent German directive **VDI 6036** is changing the way of thinking of installers, engineers and architects on safety in fixing radiators. Depending on the application and positioning of the radiator, the directive defines precise limits on the forces to be supported and the maximum permissible displacements. Higher standards are required in public places such as banks, stadiums, schools, hospitals. **TÜV SÜD** has tested compliance with the **class 3** specifications of the directive, of a series of MB FIX brackets for all types of radiator and application, in order to guarantee our customers, the safety of fixing in all situations. For all our customers we provide our machines to test the correct application of **VDI 6036**.



High-quality products by MB FIX are only for professionals from the trade. When choosing MB FIX to partner with, you can rely on perfect technology and receive a guarantee for safe and correct installation, as well as long-lasting products. Should there be any defects, you can of course, rely on the responsibility of MB FIX. You can for sure also count on MB FIX's spare parts service: Accessories and spare parts are available for many years thanks to long-term product ranges.



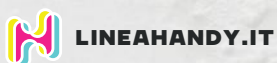

WE THINK THAT EVERY PROBLEM CAN BE SOLVED
WITH A TOUCH OF CREATIVITY

MB SRL - VIA MADONNA NERA 2/B
I - 31030 BORSO DEL GRAPPA (TV)

marketing@mb-fix.it

Ph. +39 0423 913800
Fx. +39 0423 542188