



United Nations  
Educational, Scientific and  
Cultural Organization



World  
Heritage  
Convention

## Fastening systems for multicolumn radiators

Villa "La Rotonda" is a Renaissance villa just outside Vicenza in northern Italy designed by Italian Renaissance architect Andrea Palladio. The villa's correct name is Villa Almerico Capra Valmarana.



FIX IT





ISO 9001



**interseroh**  
zero waste solutions

InterSeroh zero waste solutions



chrome free

Hexavalent chromium free



Made in Italy



**Creativity makes the world a safer place!**

We want to make the world a safer place thanks to the creativity of our mechanical fixings,  
customized to every aesthetic and functional need.



FIX IT

BRACKETS READY FOR INSTALLATION

Two ready-to-install floor brackets for tubular radiators with manifold diameter from 45 mm to 60 mm, including base cover **QKP/QKF** and cover **QKG**, both in white ABS. **PGT 60**: configuration for finished floor.  
**PGT-1 60**: configuration for raw floor.



60791560	2x PGT 60 + 2x QKP	 <b>AK3</b>	1	300
60791561	2x PGT-1 60 + 2x QKF	 <b>AK3</b>	1	150



PGT 60 for finished floor

Measures are expressed in millimeters

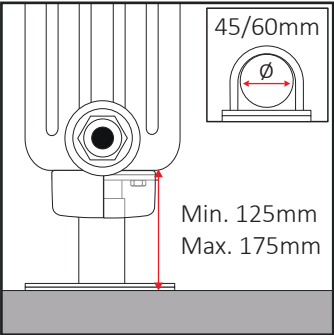

PGT-1 60 for raw floor

 Assembly instructions

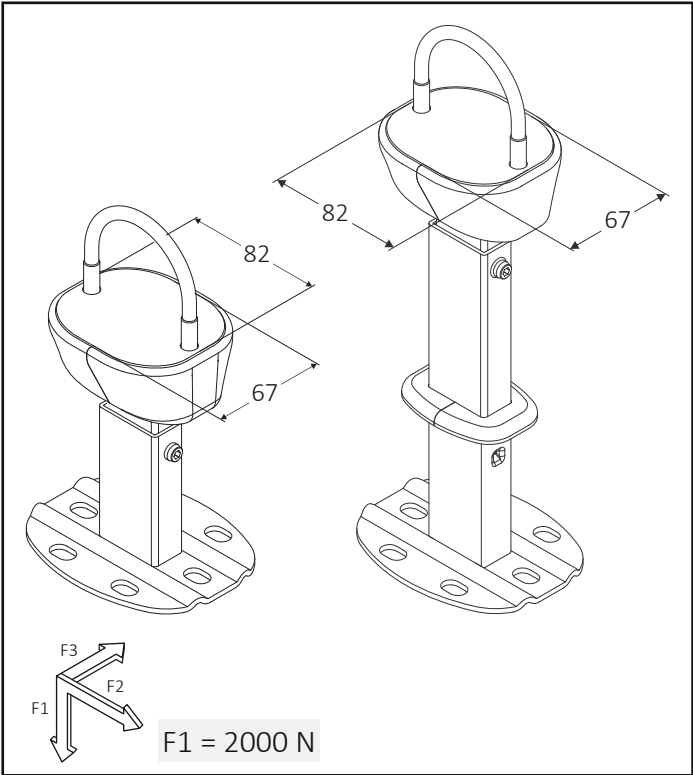
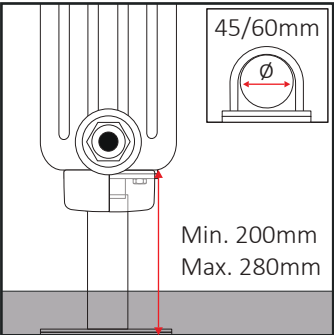

## COVERS AND EXTENSIONS

**VL**: 10 cm extension for all ready-to-install floor brackets. **QKR**: tube-cover in white ABS, for all ready-to-install floor brackets, configuration for raw or finished floor. **QKP** and **QKF**: base-cover in white ABS, supplied with all ready-to-install floor brackets.



60740004	1x VL (+ 10cm)	50	1050
60705024	2x QKR	25	2000
60705020	1x QKP	20	3000
60705022	1x QKF	20	4000



VL



QKR



QKP



QKF

Measures are expressed in millimeters

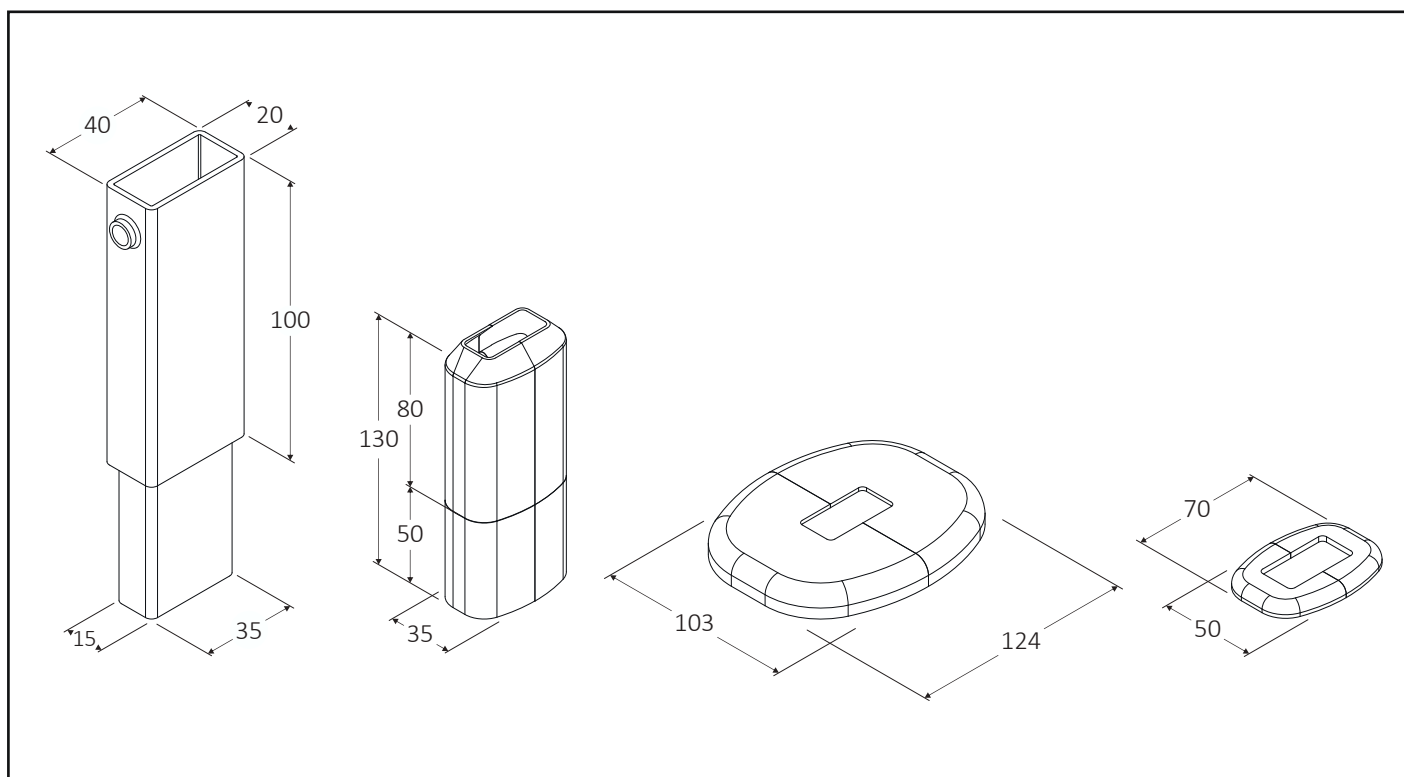



# BRACKETS READY FOR INSTALLATION

Two ready-to-install, self-supporting floor brackets for tubular radiators with 3 to 6 columns, including covers **QKE** in white ABS.

BEMM, IRSAP, RONDRA, ZEHNDER



60770101	2x PGE 101		<b>AK3</b>		1	250
60770139	2x PGE 139		<b>AK3</b>		1	150
60770177	2x PGE 177		<b>AK3</b>		1	150
60770215	2x PGE 215		<b>AK3</b>		1	110

ARBONIA, CORDIVARI, DL RADIATORS, ERCOS, ZENITH



60770107	2x PGE 107		<b>AK3</b>		1	250
60770148	2x PGE 148		<b>AK3</b>		1	150
60770189	2x PGE 189		<b>AK3</b>		1	150
60770230	2x PGE 230		<b>AK3</b>		1	110

Measures are expressed in millimeters

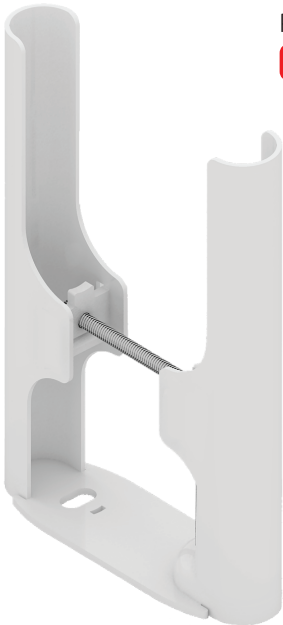

PGE  
**PATENTED**



QKE

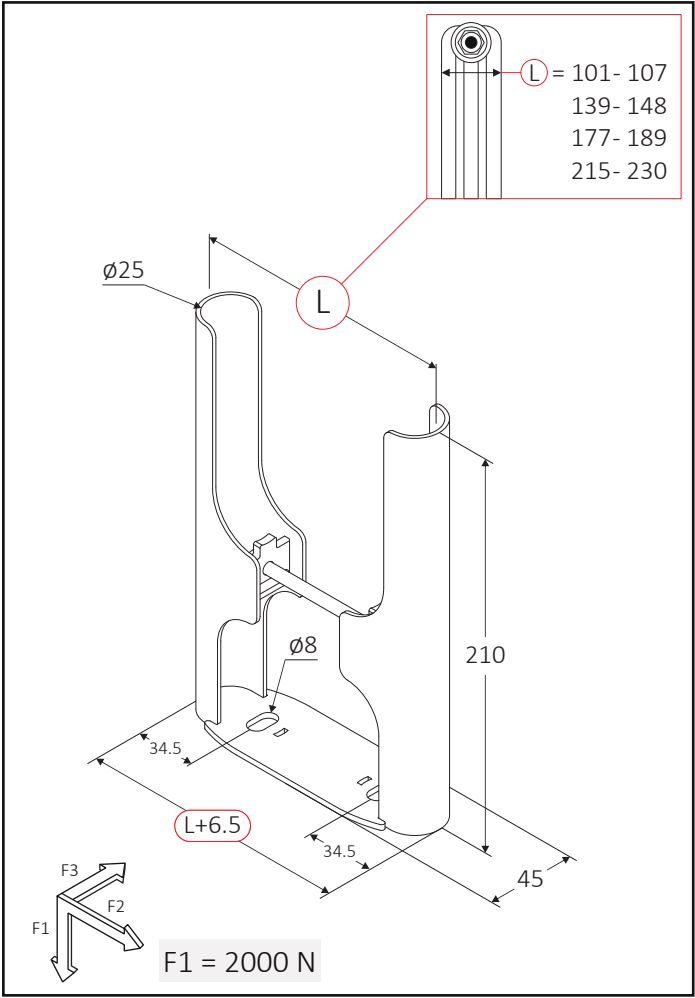

Height PGE

Maximum height

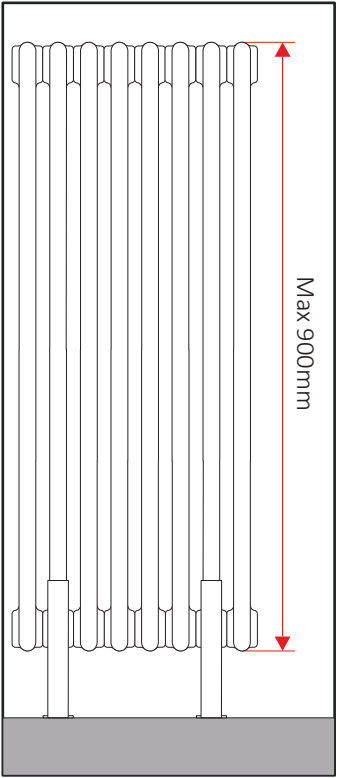
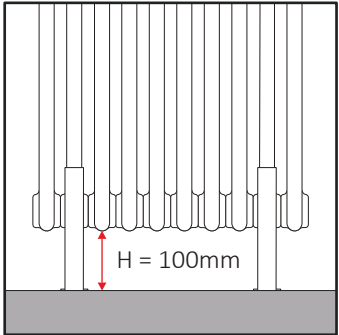

Assembly instructions



# BRACKETS READY FOR INSTALLATION

Two ready-to-install and adjustable floor brackets for tubular radiators with 2 columns, 3 or 4 columns and 5 or 6 columns, set including inserts and key, white version.



60771001	2x PGE-M		1	300
60771002	2x PGE-M		1	150
60771003	2x PGE-M		1	150



PGE-M  
From 3 to 6 columns



PGE-M  
For 2 columns

Widths PGE-M

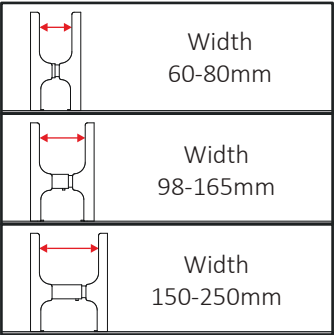

Height PGE-M

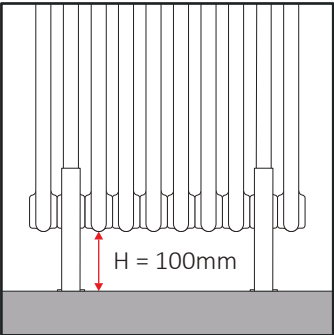

Measures are expressed in millimeters

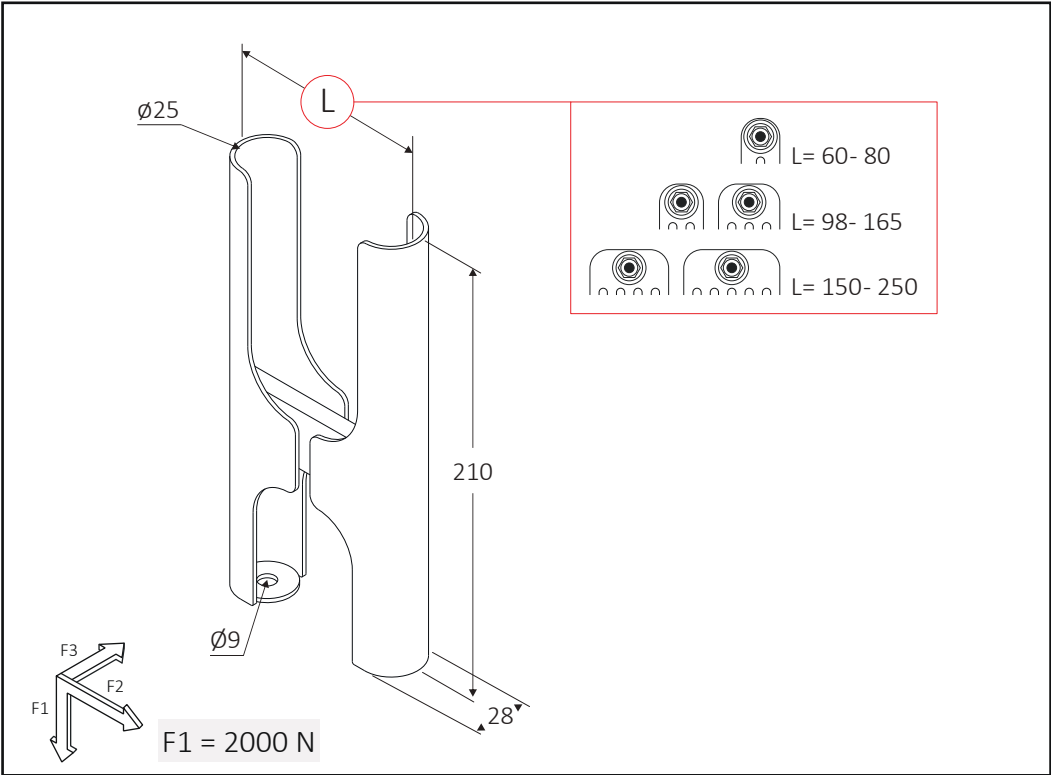



BRACKETS READY FOR INSTALLATION

Floor support bracket for tubular radiators, white version, including cover **QKF** in white ABS.



60400816D	1x STD + 1x QKF	60	960
-----------	-----------------	----	-----



Support Fistone

Measures are expressed in millimeters

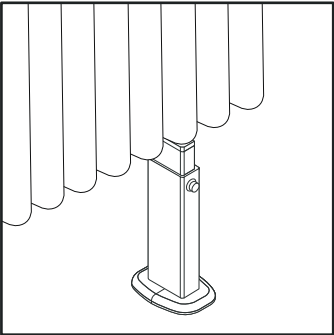

Regulation Fistone

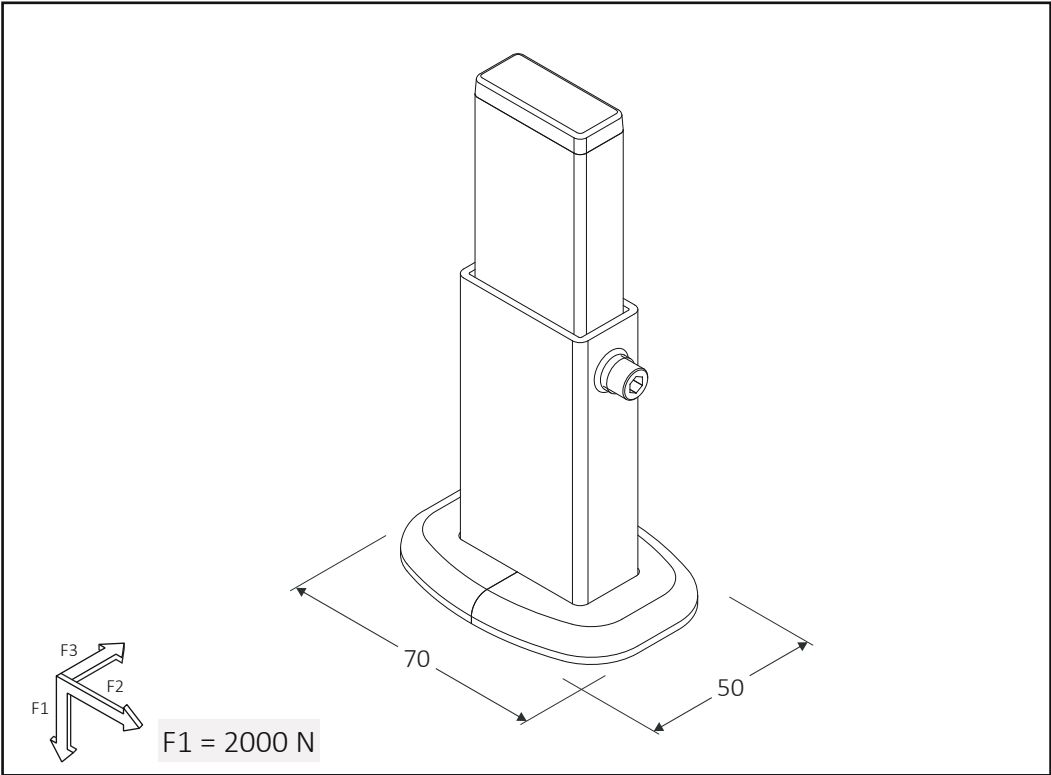
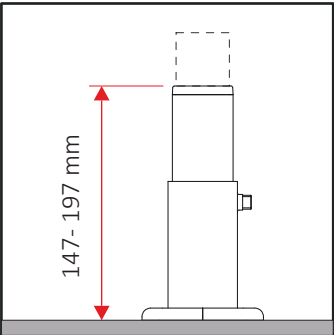

## MODULAR BRACKETS

Rectangular section tube for floor bracket composition, for radiators with height from 300 to 1000 mm.

QT



60705046	QT 460 mm	25	1500
60705056	QT 560 mm	25	1500
60705066	QT 660 mm	25	1000
60705076	QT 760 mm	25	1000
60705086	QT 860 mm	25	1000
60705096	QT 960 mm	25	1000
60705106	QT 1060 mm	25	1000
60705116	QT 1160 mm	25	1000

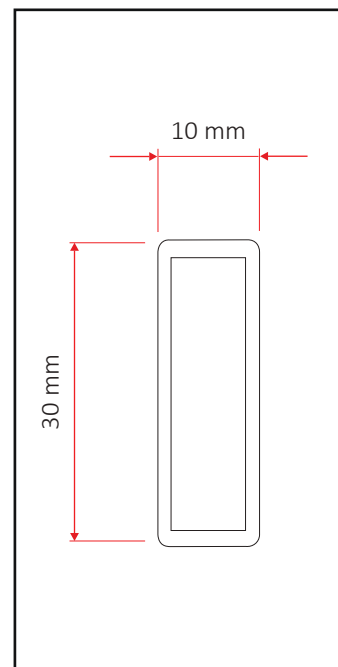

Base with central tube, for floor bracket composition, with rectangular tube model **QT**.

QB



QK

60705000	QB	50	2500
60705012	QK	20	3000

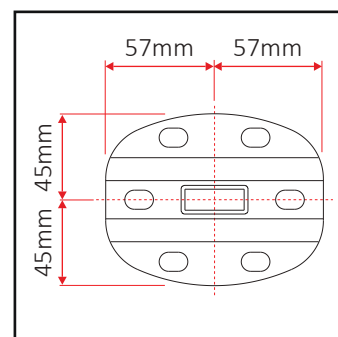

Base with decentralized tube, for floor bracket composition, with rectangular tube model **QT**.

QBX



QKX

60705005	QBX	50	2500
60705013	QKX	20	4000

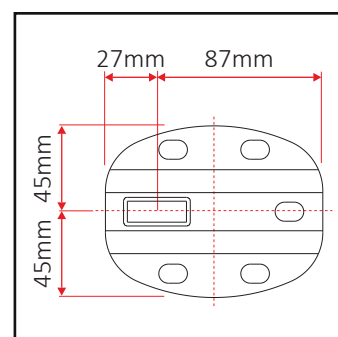



## MODULAR BRACKETS

Kit of 4 elements for floor bracket composition, with rectangular section tube model **QT**, composed of: lower hook with plastic insulator **QG1**, retainer for radiator **QG2**, insulator **Q10** for rectangular tube and upper cap **Q9**.



60705400

QGN: 1x QG1 + 1x QG2 + 1x Q10 + 1x Q9

50

2750

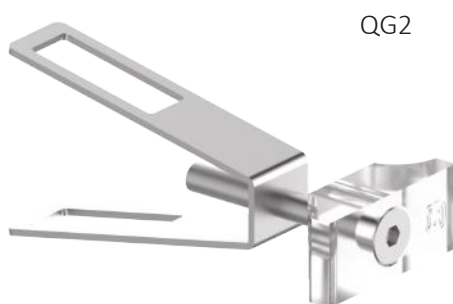

QG2

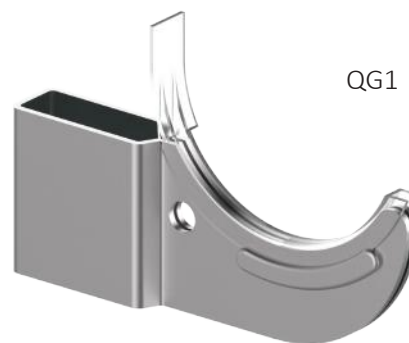

QG1



Q9  
Transparent



Q10  
Transparent

Distance QGN

Measures are expressed in millimeters

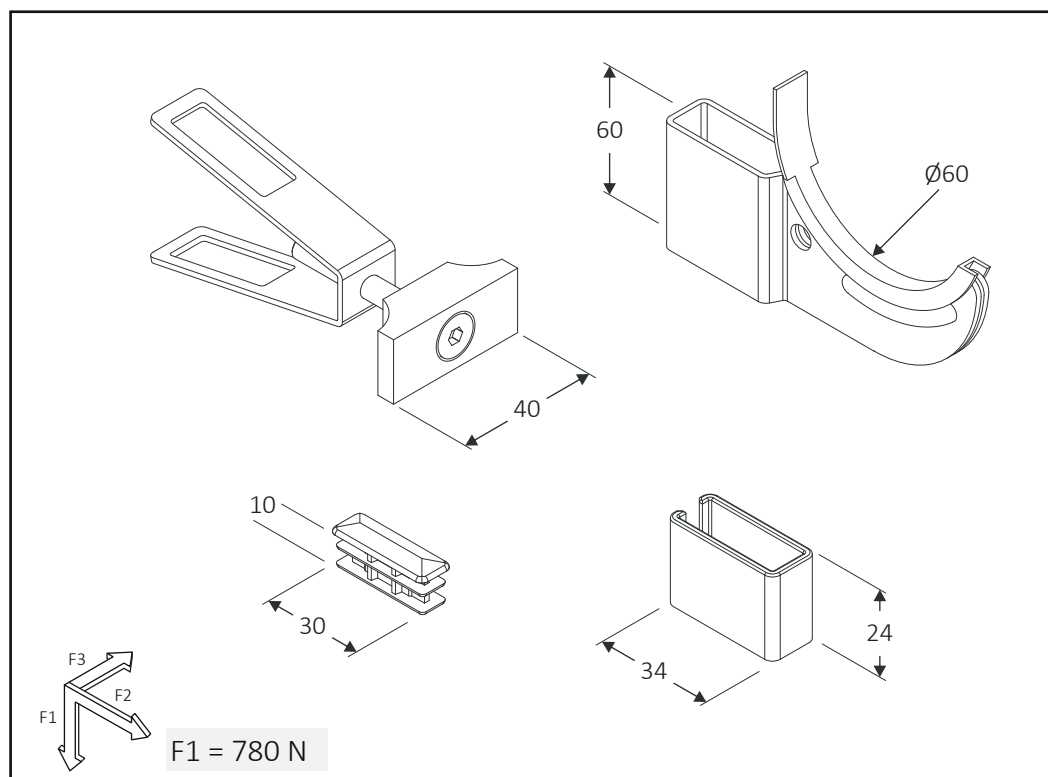
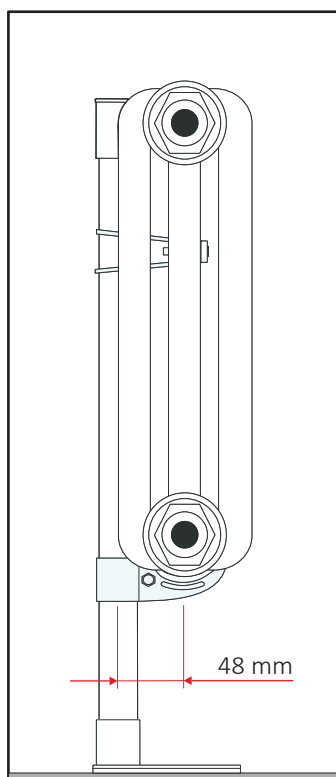

CAST IRON BRACKETS

**PGG:** Cast iron foot to support multicolumn radiators, white color, single packaging in bubble wrap. **BG3:** Two wall brackets with two transparent clamps for fixing the radiator tubes. Adjustment for distance from wall (26-48 mm).



60770010	1x PGG	50	1000
60400600T	2x BG3	50	2500



BG3



PGG

Distance BG3 and PGG

Measures are expressed in millimeters

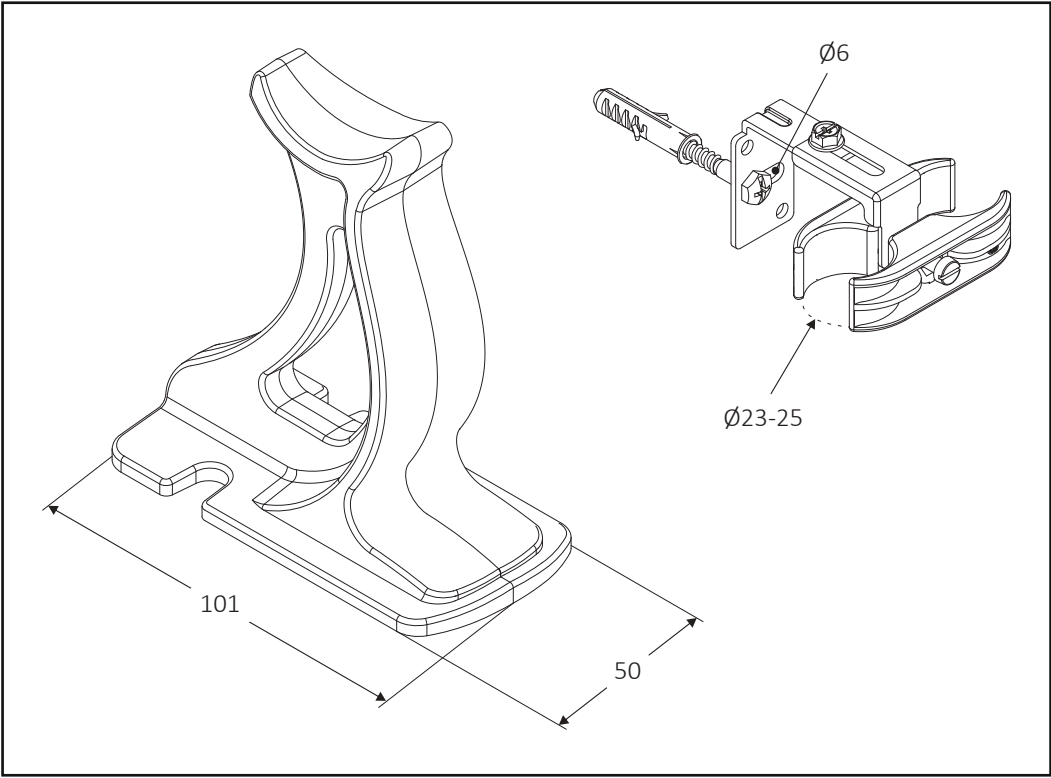
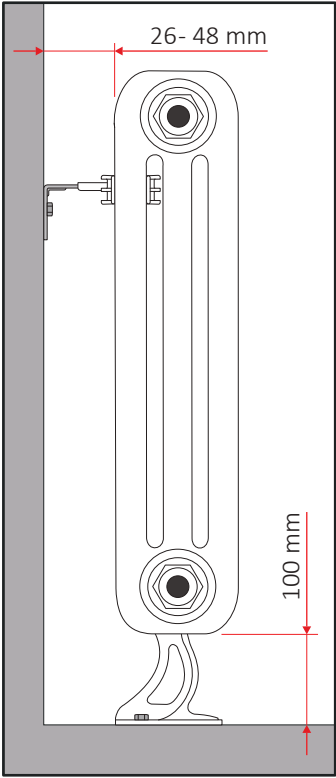



## WALL RAIL BRACKETS

Wall bracket for quick mounting, with two transparent clamps for fixing the radiator, suitable for the installation of radiators with height up to 1.000 mm. **GTXP**: Wall bracket with transparent clamp, suitable for the use with bracket **GTX**, for radiators with height over 1.000 mm.

60640026	1x GTX 260		<b>AK3</b>	20	800
60640035	1x GTX 350		<b>AK3</b>	20	640
60640045	1x GTX 450		<b>AK3</b>	20	560
60640070	1x GTX 700		<b>AK3</b>	20	280
60640100	1x GTXP		<b>AK3</b>	20	1100

Measures are expressed in millimeters

Height GTX and GTXP

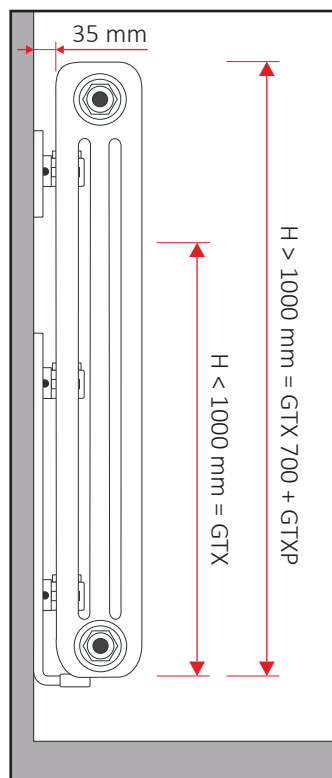
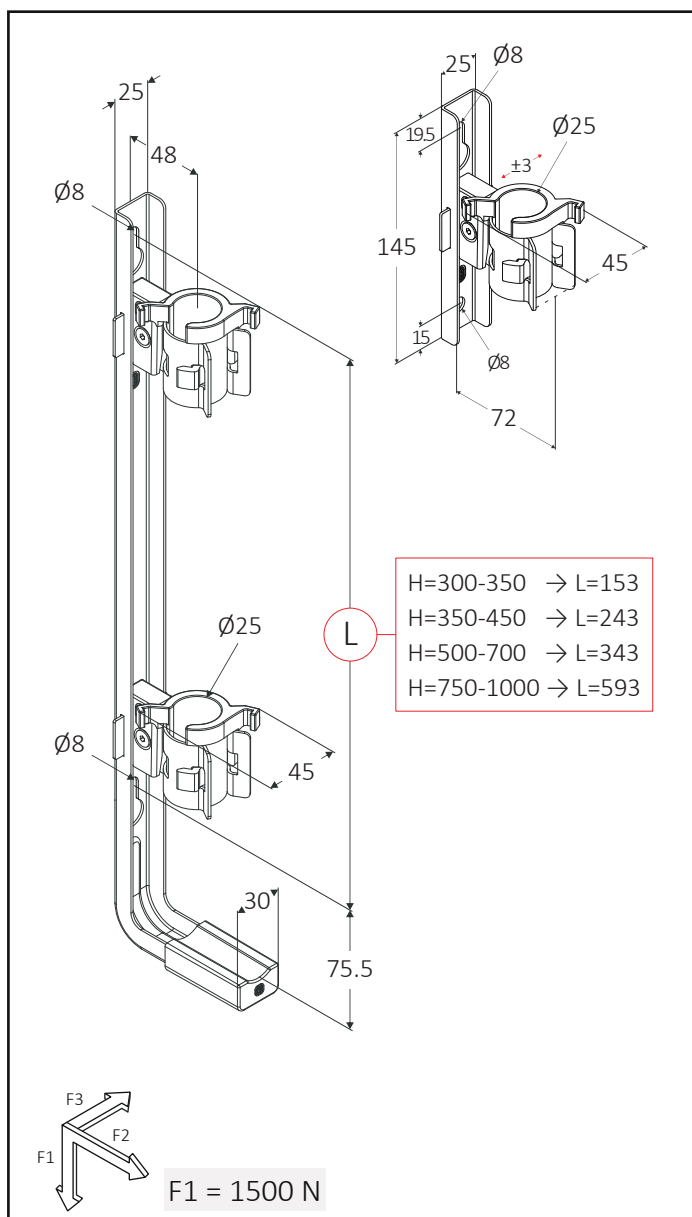

 Assembly instructions



GTX

**PATENTED**

GTXP

**PATENTED**

## WALL BRACKETS

Two wall brackets with anti-lift cover **QKS** and transparent spacer **N6**.



60201002

2x GBT + 2x QKS + 2x N6



**AK3**

20

800



Distance GBT

Measures are expressed in millimeters

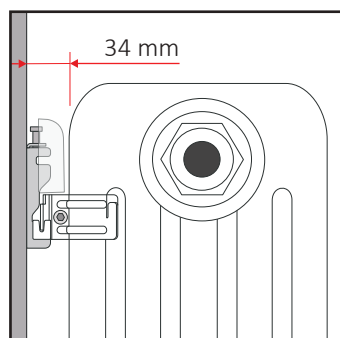

Assembly instructions

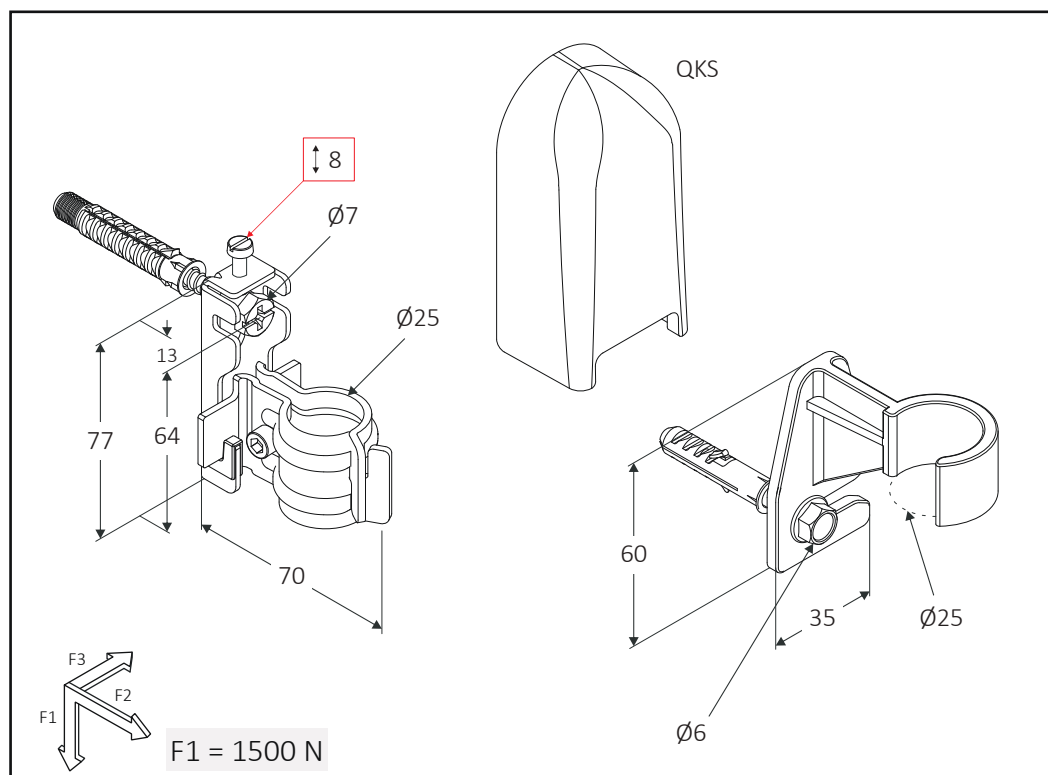



WALL BRACKETS

Two brackets for quick wall mounting with clamps **OT** and spacers **N5**, all in white color. Options for distance from wall (30-40 mm). Plastic insulators included.



60400740	2x D2 + 2x OT + 2x N5	50	1200
----------	-----------------------	----	------

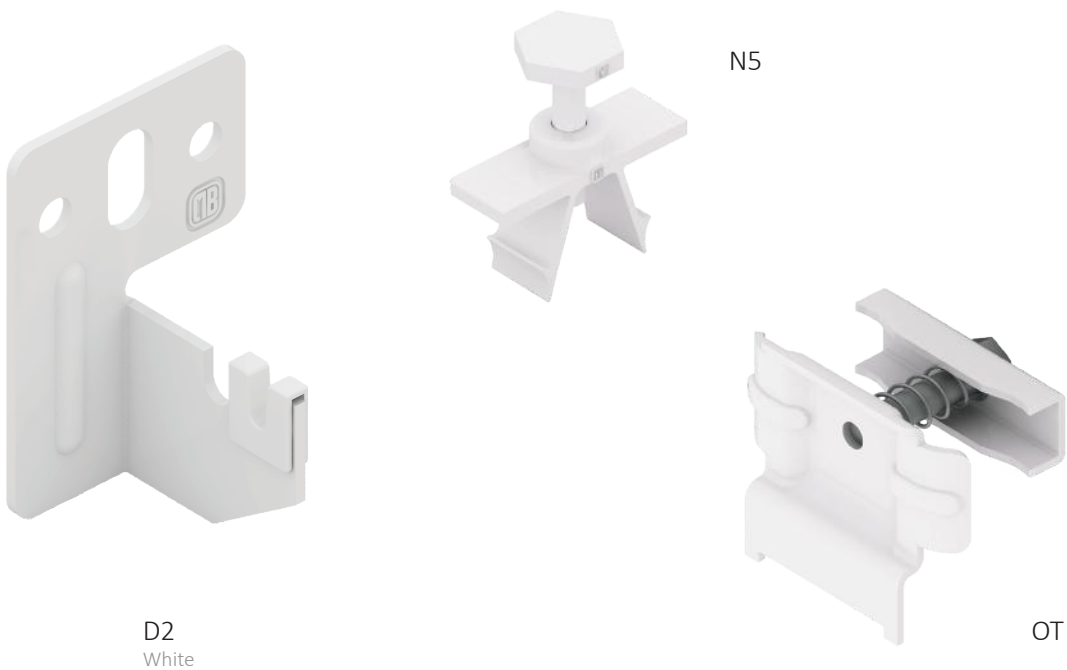

Distance D2 OT N5

Measures are expressed in millimeters

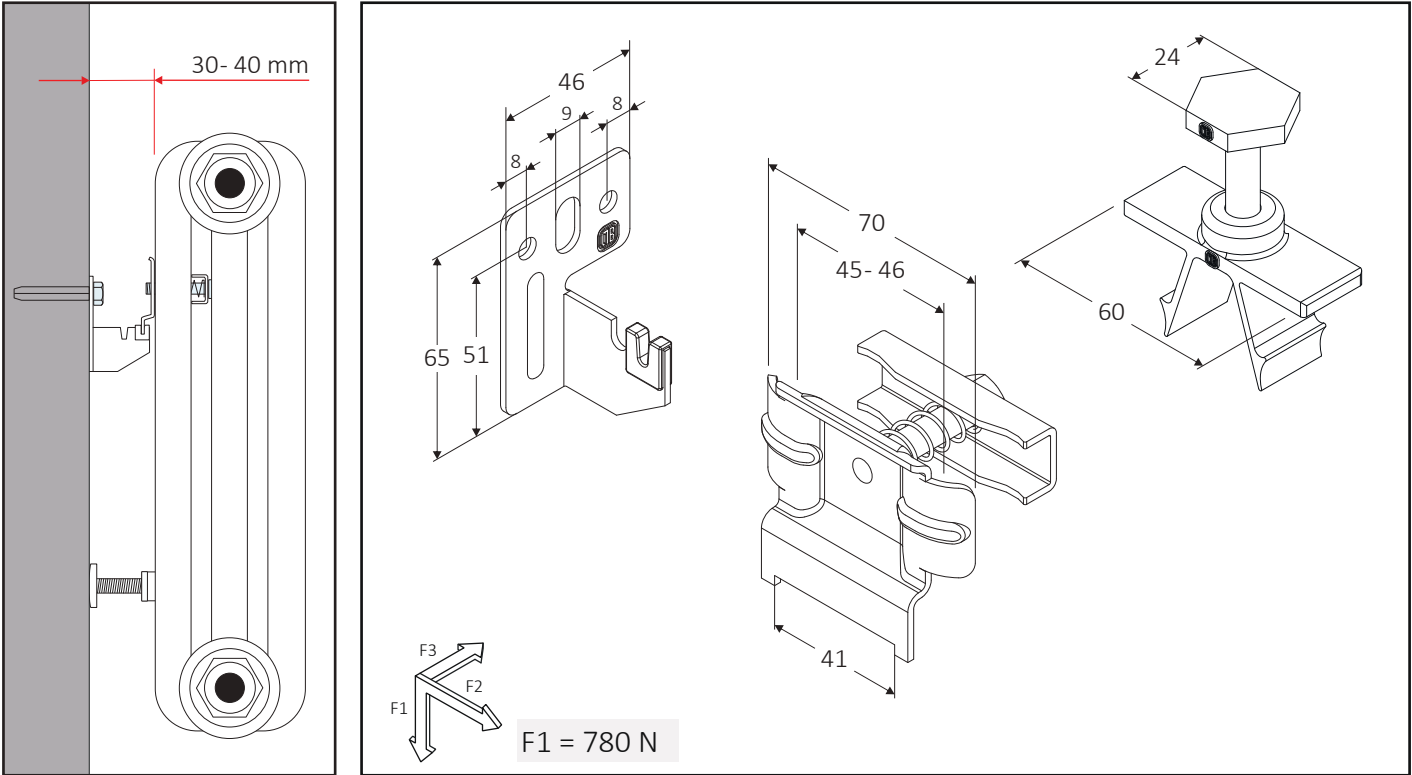

## WALL BRACKETS

Two brackets for quick wall mounting of tubular radiators in horizontal version, possibility of vertical adjustment and distance from wall, white version. **N5+NP**: spacers in transparent plastic. **SC3H**: anti-lift security. Galvanized version on request.



60400542	2x D3 + 2x OTH + 2x SC3H + 2x N5 + 2x NP	50	1600
----------	--	----	------



D3  
White



SC3H

N5  
Transparent



NP  
Transparent



OTH

Distance D3 OTH

Measures are expressed in millimeters

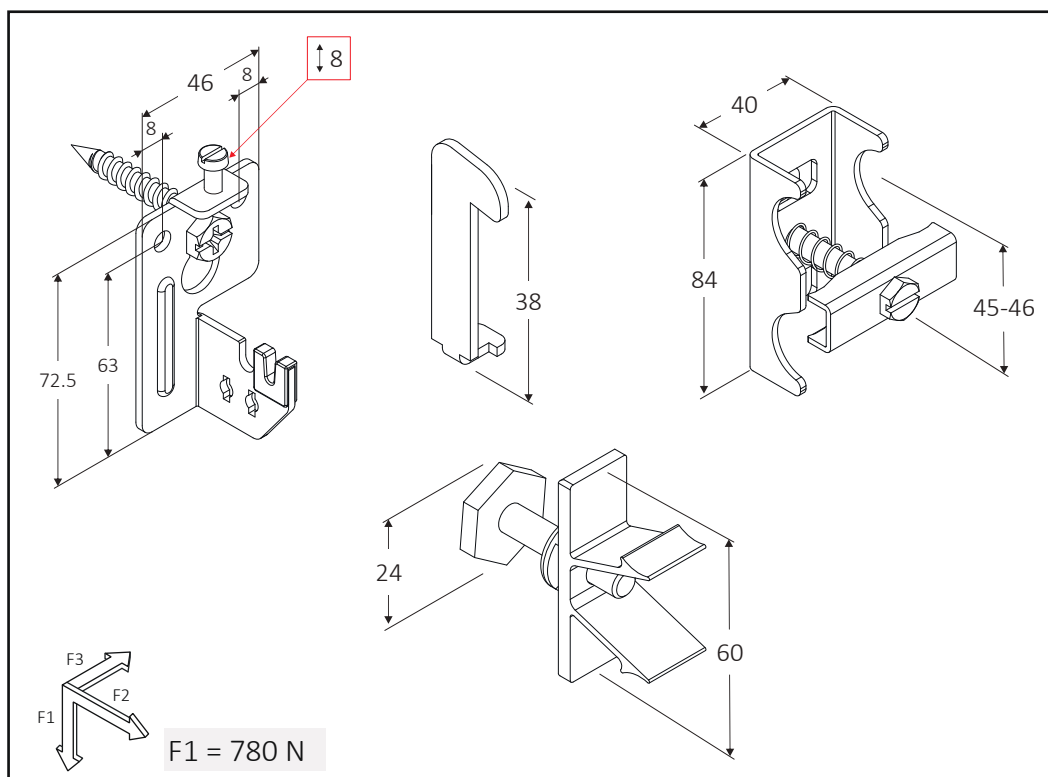
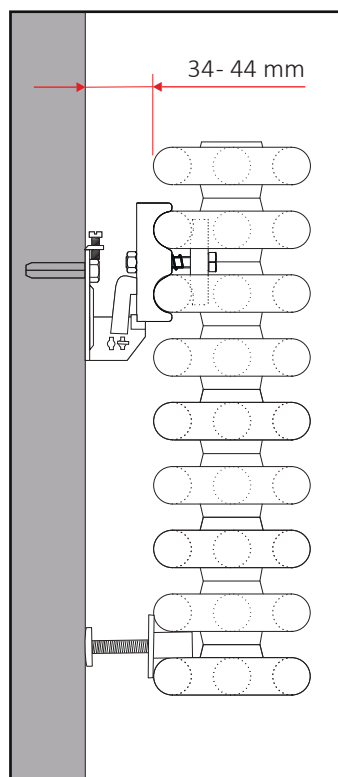

WALL BRACKETS

Two wall brackets with percussion  $\varnothing 12\text{mm}$ , for quick wall mounting of tubular radiators, manifold diameter from 45mm to 60mm, white version.



60211650	2x R12V L = 50 - 80	50	2500
60211651	2x R12V L = 80 - 110	50	2000
60211652	2x R12V L = 110 - 140	50	1500



R12V

Distance R12V

Measures are expressed in millimeters

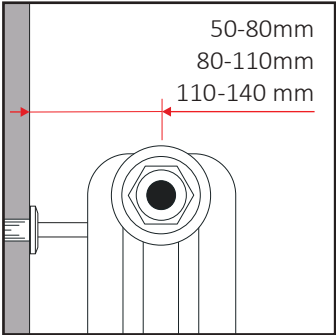

Manifold dimensions

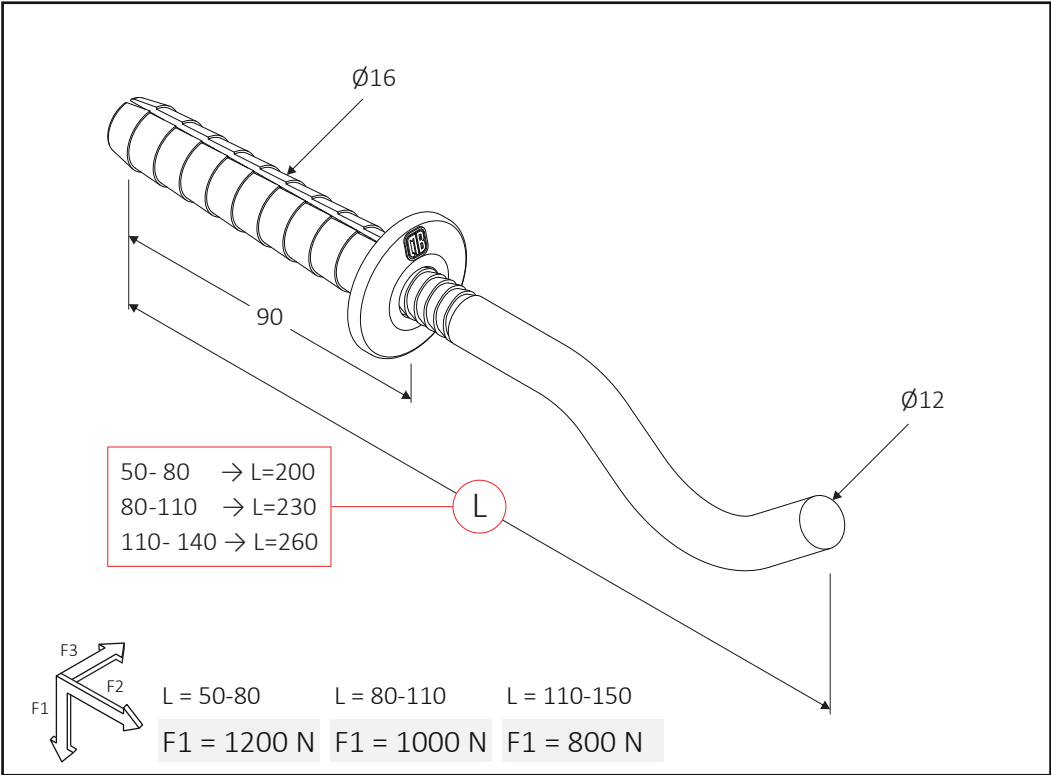
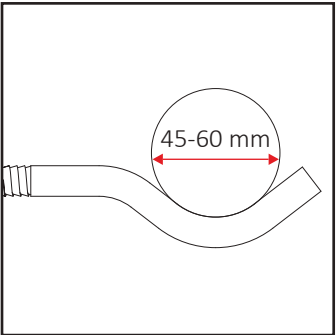



WALL BRACKETS

Two wall brackets for quick wall mounting of tubular radiators, length 70mm or 105mm.



60210173	2x T1G L=70	50	3300
60210174	2x T1G L=105	50	3300

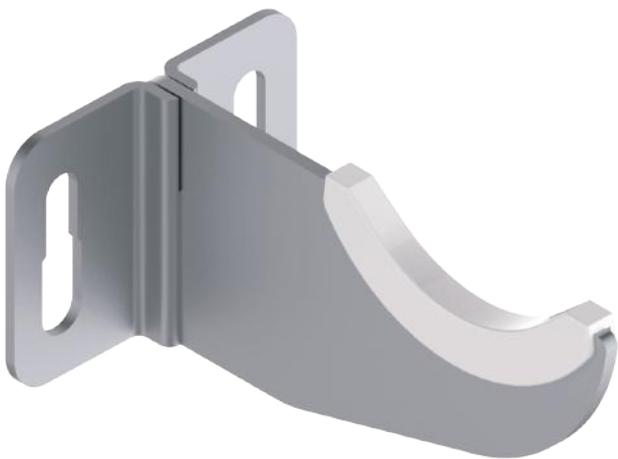

T1G

Distance T1G

Measures are expressed in millimeters

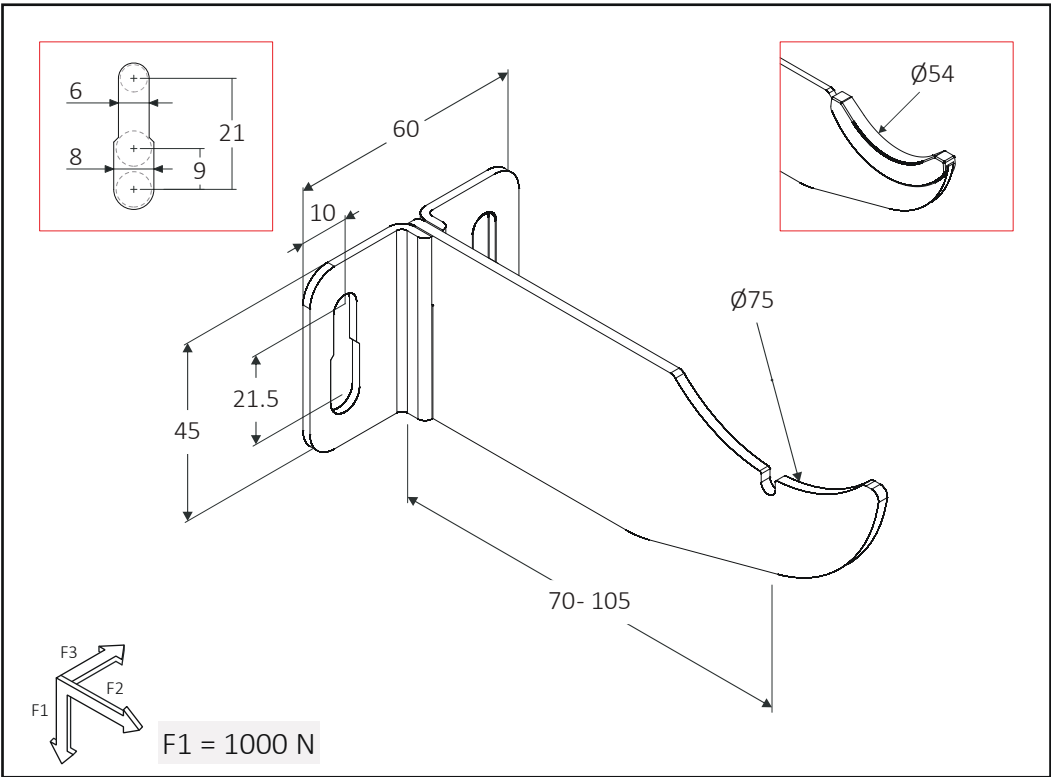
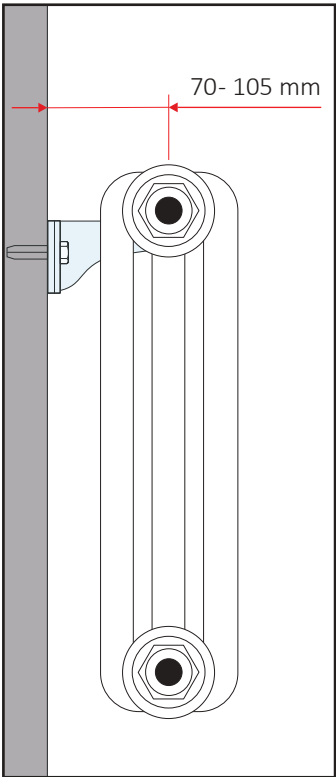

WALL BRACKETS

Ready-to-install wall bracket for cast iron radiators, tubular radiators can also be installed by using the insulator provided.



60005191	2x M2	50	1600
----------	-------	----	------



M2





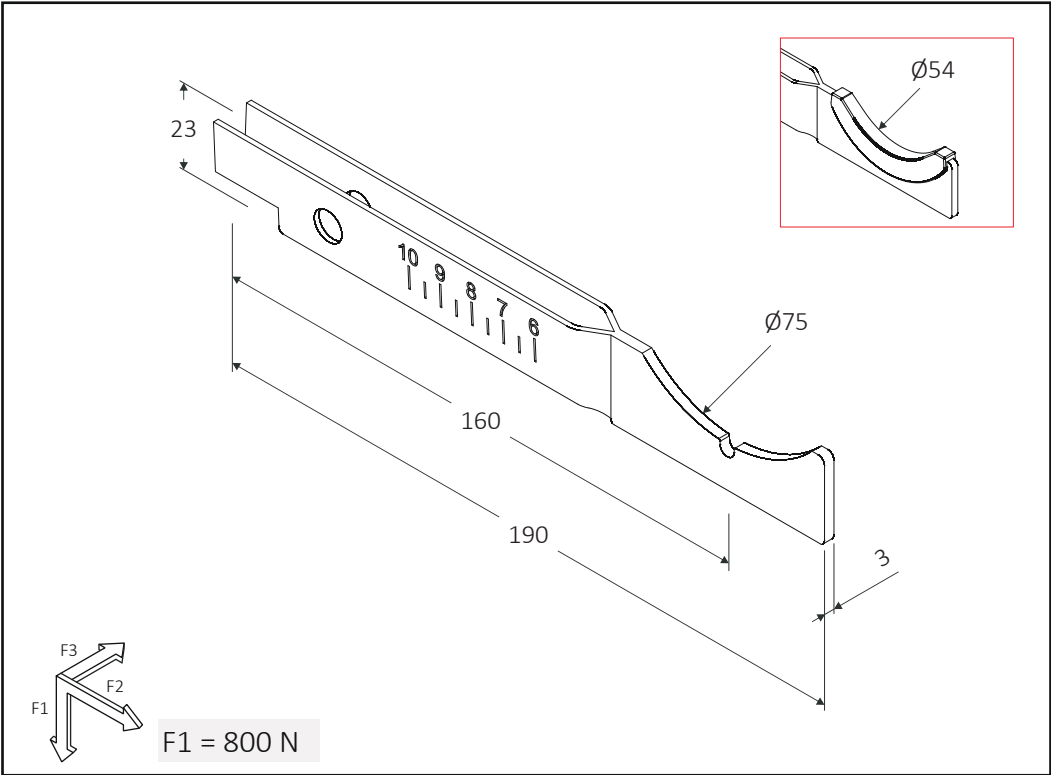
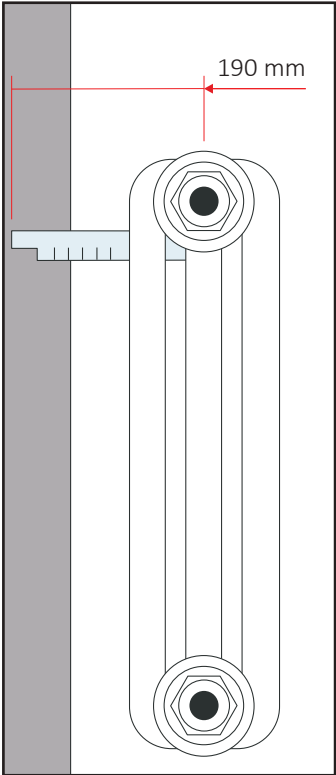









Distance M2

Measures are expressed in millimeters



BRACKETS READY FOR INSTALLATION

Two brackets for quick wall or plasterboard mounting, with cover **QKM7** in white color. Hook in white color or galvanized. Height regulation. Plastic insulators included.

						
60210220	2x M7C L=53 + QKM7				18	576
60210222	2x M7C L=74 + QKM7				18	576
60210224	2x M7C L=94 + QKM7				18	576
60210226	2x M7C L=115 + QKM7				18	576
						
60210221	2x M7C L=53 + QKM7				18	576
60210223	2x M7C L=74 + QKM7				18	576
60210225	2x M7C L=94 + QKM7				18	576
60210227	2x M7C L=115 + QKM7				18	576

QKM7



M7C



Distance M7C

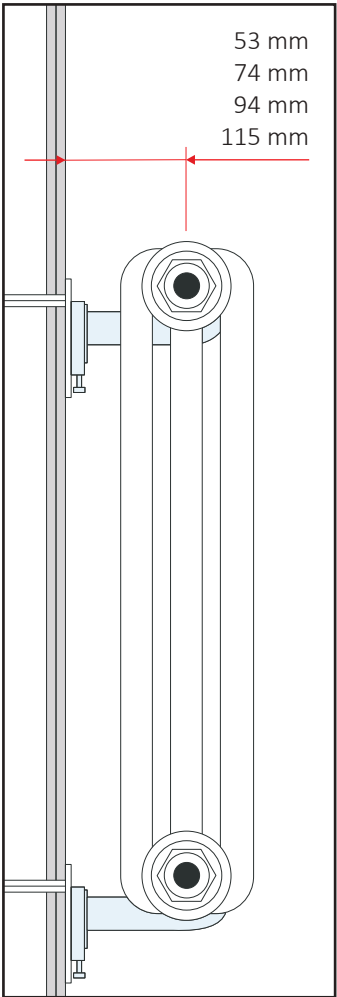

Measures are expressed in millimeters

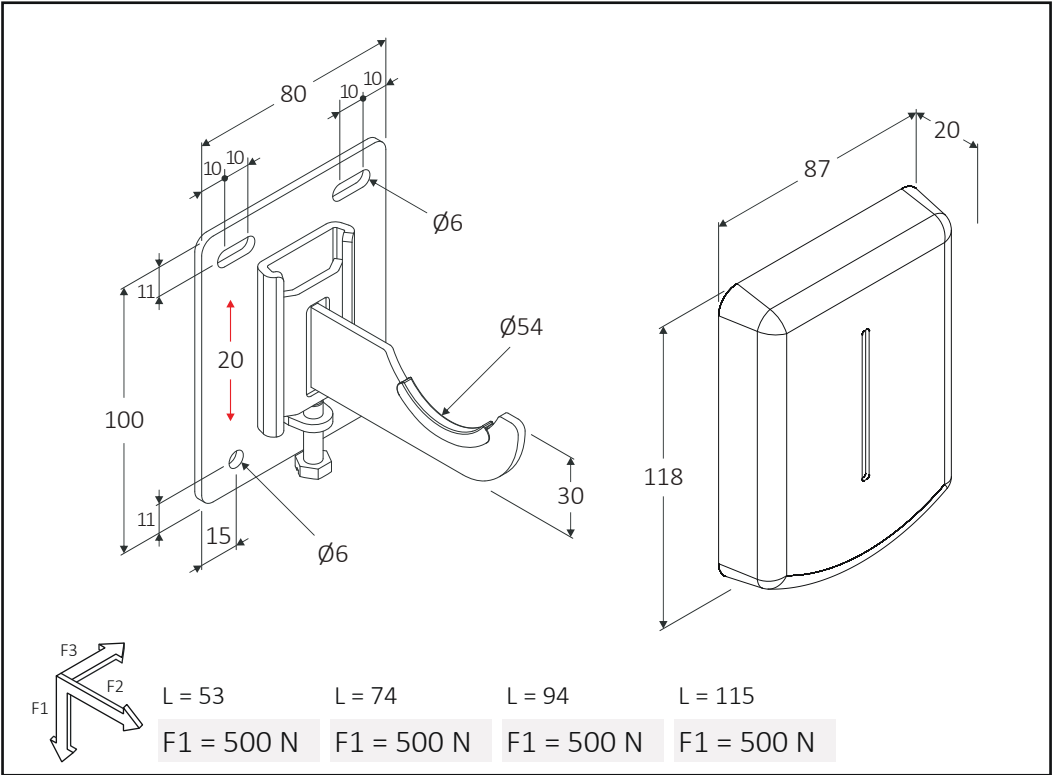

EXPANSION BRACKETS

Kit of two expansion brackets for tubular radiators and supports **CK**. Adjustment for distance from wall (12-45 mm).  
**OT**: Clamp for fixing tubular radiators. **N5**: Transparent spacer for adjusting distance from wall.



60511090	2x C 90 + 2x CK	50	5500
60511120	2x C 120 + 2x CK	50	2750
60511160	2x C 160 + 2x CK	50	2500
60511180	2x C 180 + 2x CK	50	2500
60511240	2x C 240 + 2x CK	50	2000
60500742	OT	100	5500
60020251T	N5	100	5500

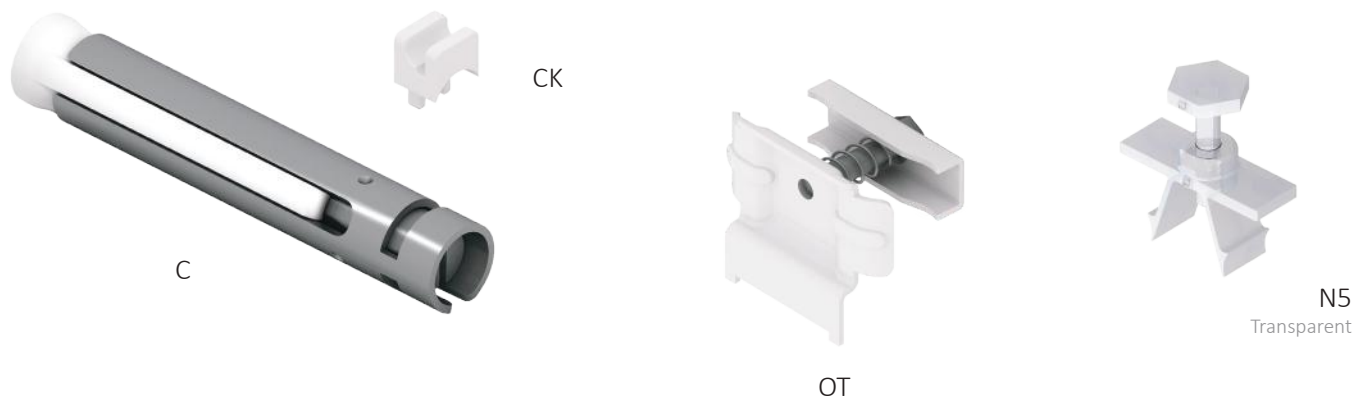

Distance C CK

Measures are expressed in millimeters

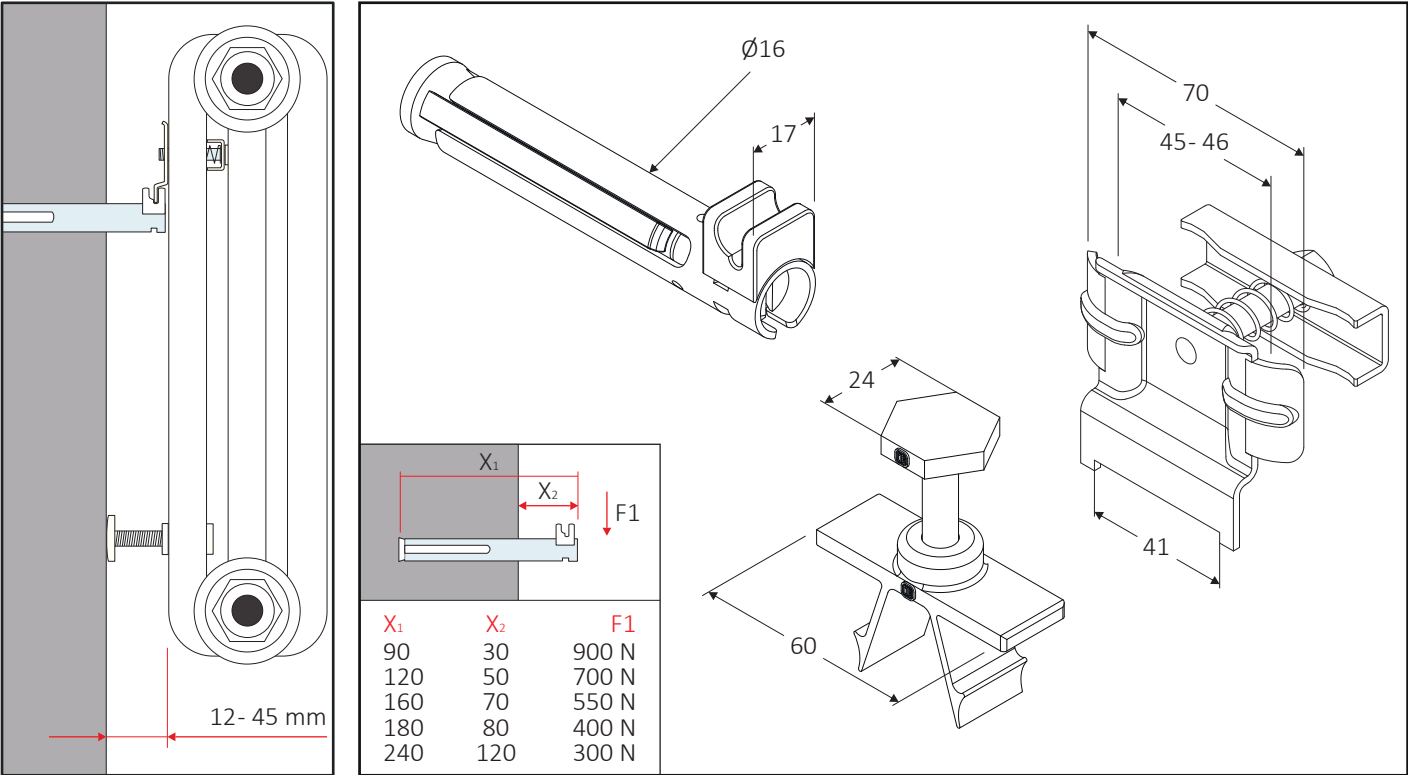



EXPANSION BRACKETS

Kit of two expansion brackets for cast iron radiators and supports **CK**. Adjustment for distance from wall (12-45 mm).  
**OG**: Clamp for fixing cast iron radiators.



60511090	2x C 90 + 2x CK	50	5500
60511120	2x C 120 + 2x CK	50	2750
60511160	2x C 160 + 2x CK	50	2500
60511180	2x C 180 + 2x CK	50	2500
60511240	2x C 240 + 2x CK	50	2000
60500760	OG	100	5500



CK



C

OG

Installation C CK OG

Measures are expressed in millimeters

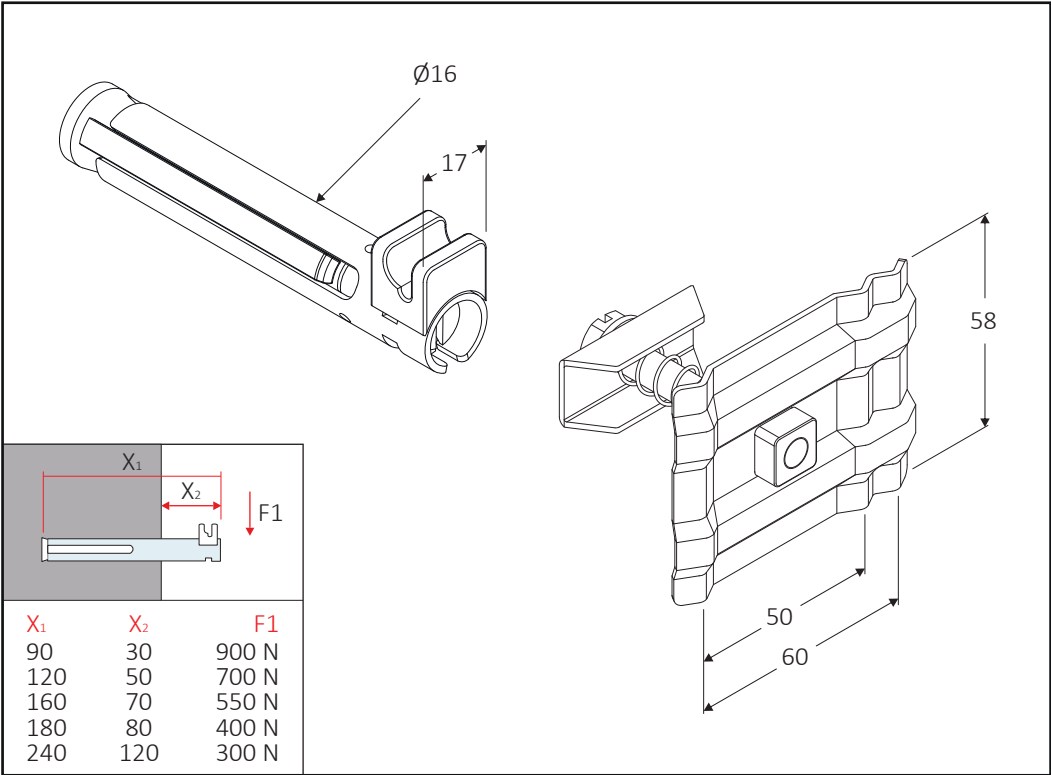
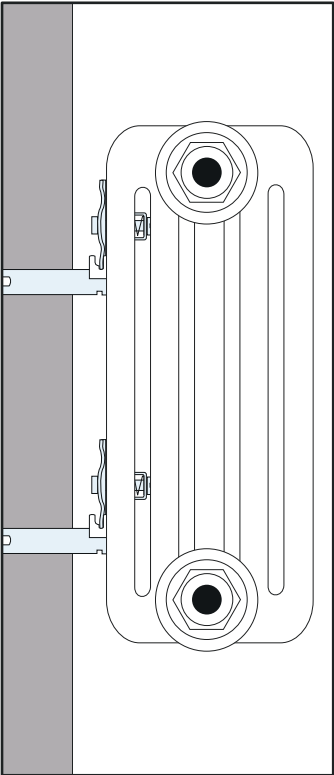

ACCESSORIES

Kit of 2 ledge holders for tubular radiators.



60751040	2x QX4	1	500
----------	--------	---	-----

QX4  
Ledge holder

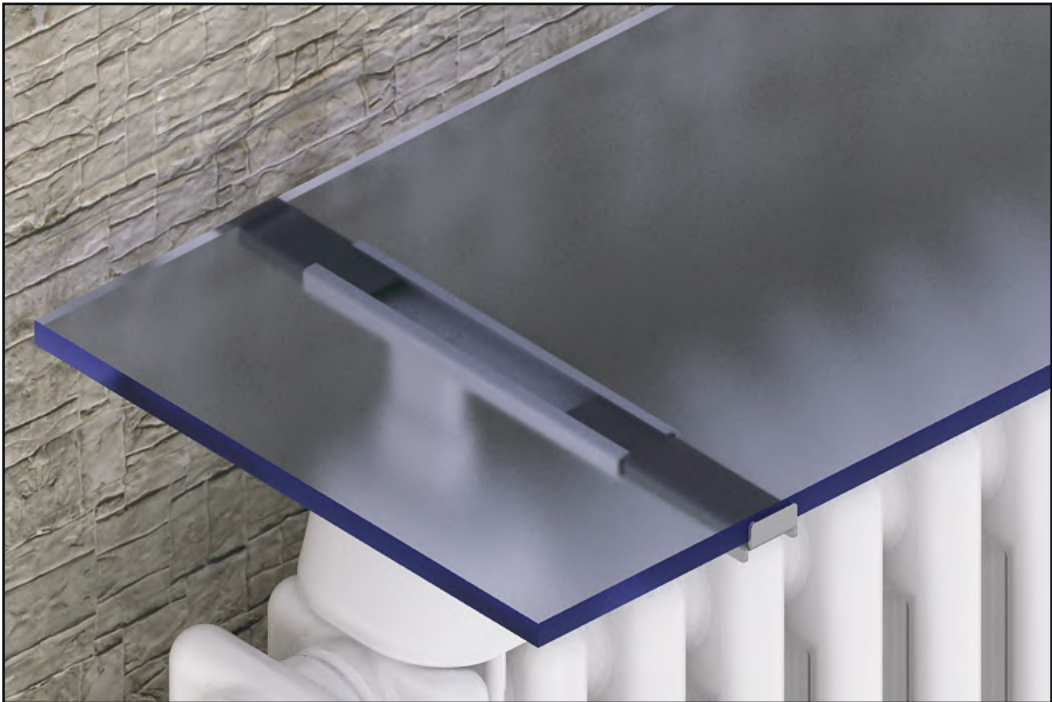

Regulation QX4

Measures are expressed in millimeters

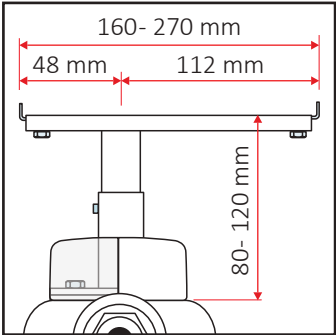

Manifold dimensions

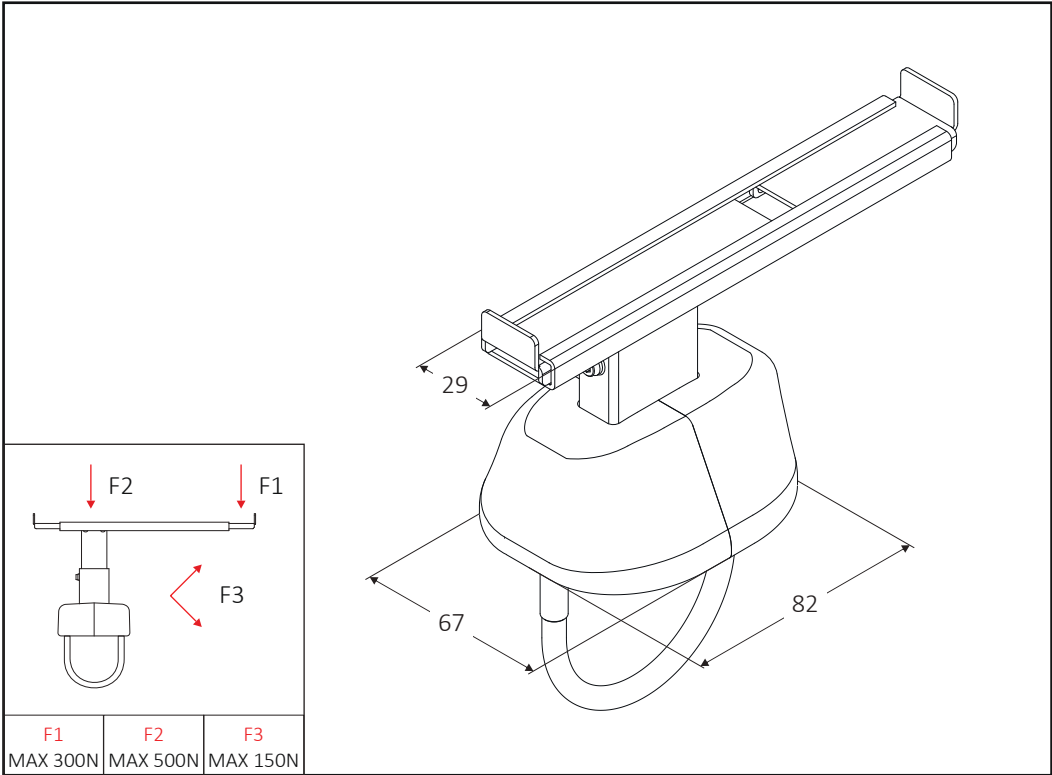
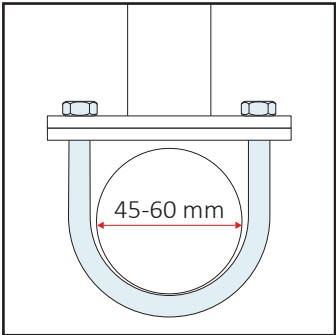

ACCESSOIRES

Kit of two supports for bench construction on 6-column radiators. Distance from radiator to bench = 60 mm.  
Available narrow or large version, according to the radiator manufacturer.

BEMM, IRSAP, RONDRA, ZEHNDER



60780215	2x PGP 215		1	110
----------	------------	---	---	-----

ARBONIA, CORDIVARI, DL RADIATORS, ERCOS, ZENITH

60780230	2x PGP 230		1	110
----------	------------	---	---	-----

PGP  
Support for bench



Distance PGP

Measures are expressed in millimeters

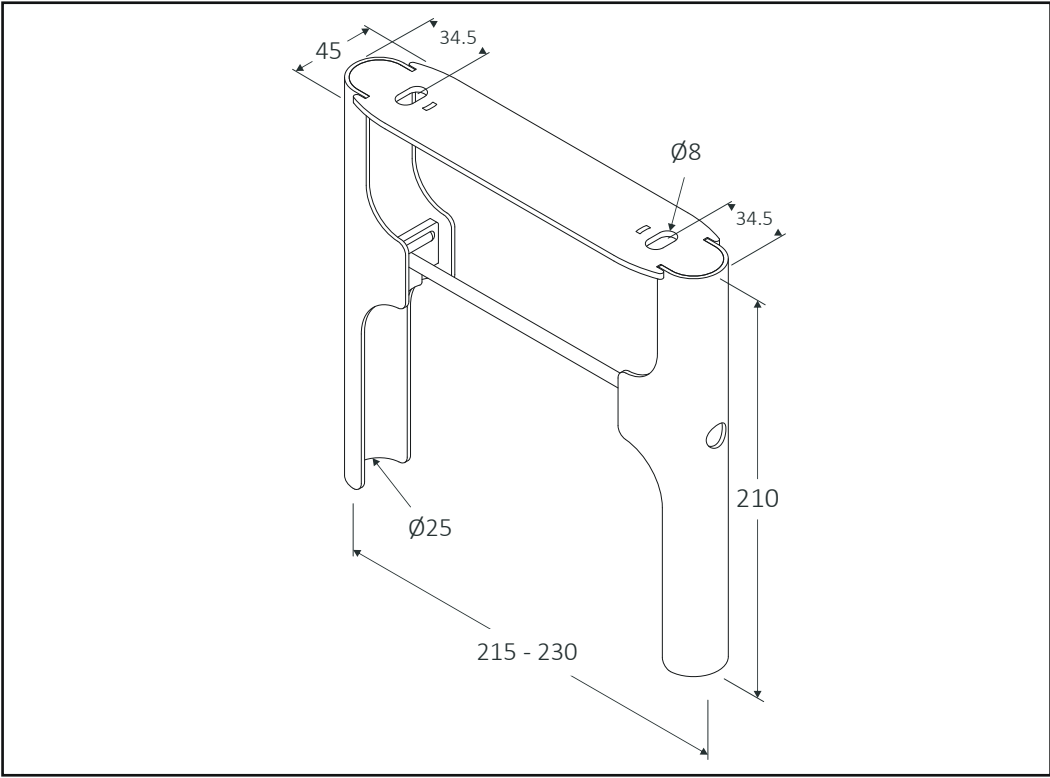
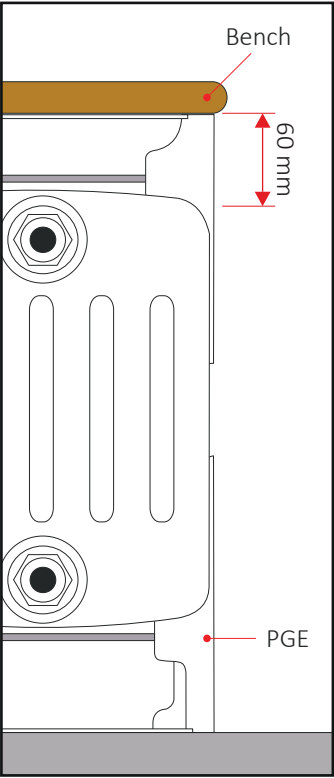

ACCESSOIRES

Kit of two floor brackets for the bench construction through the use of tubular radiators fixed horizontally, for **2, 4 and 6 columns**, white version. Raw or galvanized version on request. Kit does not include seat/shelf.



ON REQUEST

2x PTP



1

PTP

For radiators with 2-4-6 columns



Measures are expressed in millimeters

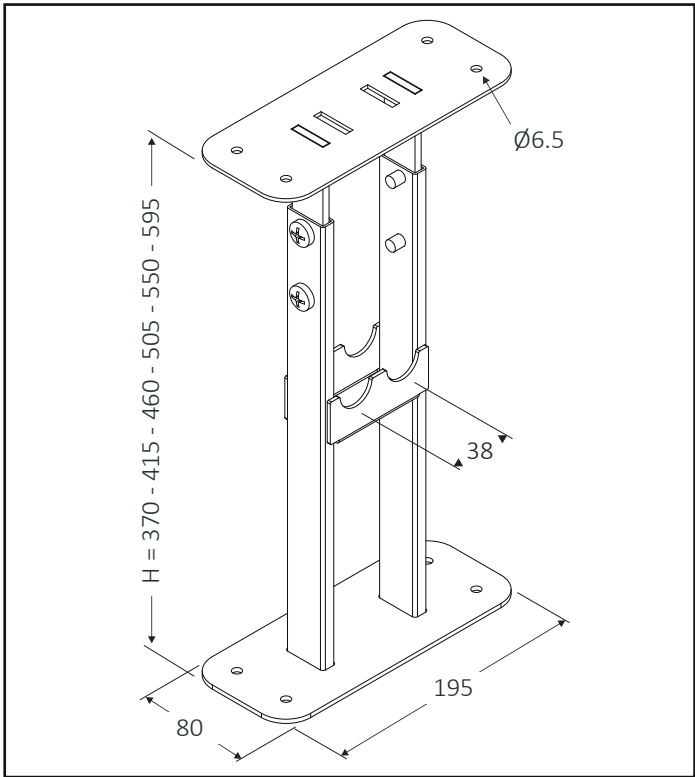



## ACCESSOIRES

Kit of two floor brackets for the bench construction through the use of tubular radiators fixed horizontally, for **3 and 5 columns**, white version. Raw or galvanized version on request. Kit does not include seat/shelf.



ON REQUEST

2x PTD



1

PTD

For radiators with 3-5 columns

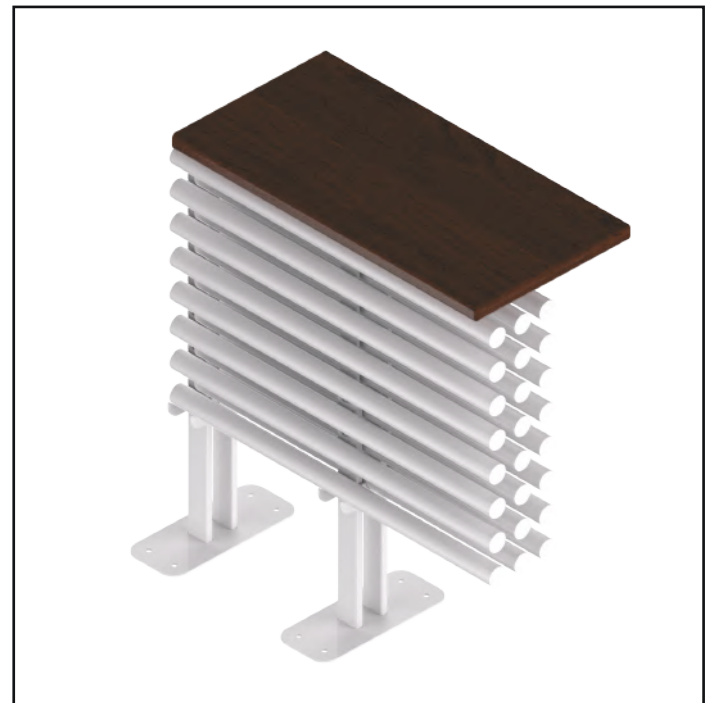

Measures are expressed in millimeters

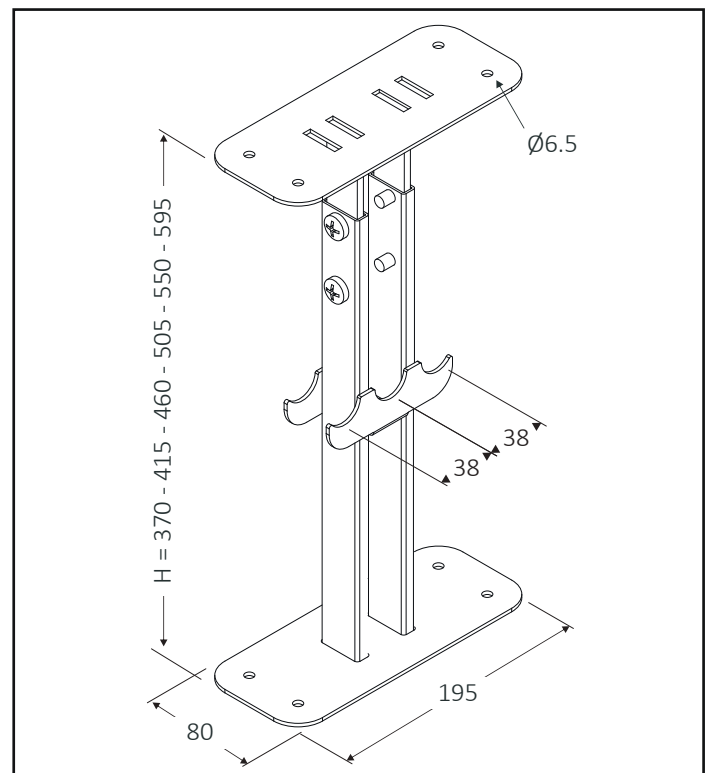



Our fixing systems are painted with white epoxy powders and a high degree of brilliance. We are also able to supply them in a series of special colors, to better adapt to the environment in which they are mounted.

### **Have it your RAL: off the charts!**

Upon request, it is possible to have certain items in particular RAL. A surcharge of 40% on the standard price is required for these items. Minimum net order € 500,00. In case of orders below the minimum, an extra € 100,00 must be added. These items are excluded from returns.







The recent German directive **VDI 6036** is changing the way of thinking of installers, engineers and architects on safety in fixing radiators. Depending on the application and positioning of the radiator, the directive defines precise limits on the forces to be supported and the maximum permissible displacements. Higher standards are required in public places such as banks, stadiums, schools, hospitals. **TÜV SÜD** has tested compliance with the **class 3** specifications of the directive, of a series of MB FIX brackets for all types of radiator and application, in order to guarantee our customers, the safety of fixing in all situations. For all our customers we provide our machines to test the correct application of **VDI 6036**.



High-quality products by MB FIX are only for professionals from the trade. When choosing MB FIX to partner with, you can rely on perfect technology and receive a guarantee for safe and correct installation, as well as long-lasting products. Should there be any defects, you can of course, rely on the responsibility of MB FIX. You can for sure also count on MB FIX's spare parts service: Accessories and spare parts are available for many years thanks to long-term product ranges.







# LET'S HELTER



LINEAHANDY.IT



LINEAHANDY



LETSHELTER



LINEAHANDY





WE THINK THAT EVERY PROBLEM CAN BE SOLVED  
WITH A TOUCH OF CREATIVITY

MB SRL - VIA MADONNA NERA 2/B  
I - 31030 BORSO DEL GRAPPA (TV)

marketing@mb-fix.it

Ph. +39 0423 913800  
Fx. +39 0423 542188